

WALL

INSTALLATION INSTRUCTIONS

CONTENTS

1. WALL PRODUCTS	3
2. WALL INSTALLATION WITH SKIN TAPE AND INCOLLAFACILE ADHESIVE	4
2.1 Installation accessories and tools	4
2.2 Installation instructions for W1A and W1B	5
2.3 Installation instructions for WMAXI	8
3. WALL INSTALLATION WITH SCREWS	9
3.1 Installation accessories and tools	9
3.2 Instructions for wall installation with screws: pre-drilled panel	10
3.3 Installation instructions for W1A and W1B	12

1. WALL PRODUCTS

Wall products are applied in a distinctly simple, fast and clean manner, adhering to walls with concealed or visible accessories.

The single module is available in two versions, W1A and W1B, and allows you to create compositions of various sizes to suit your aesthetic and space requirements. The WMAXI version, which consists of 8 modules, is designed to optimize installation time on particularly large surfaces.

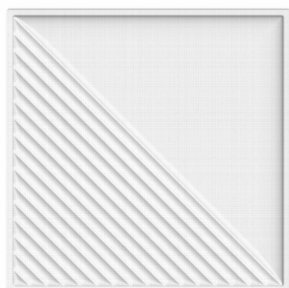

W1A (60 x 60 cm)

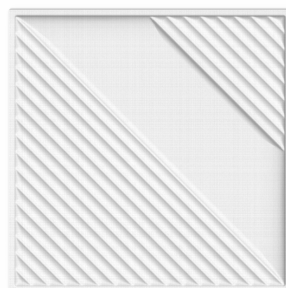

W1B (60 x 60 cm)

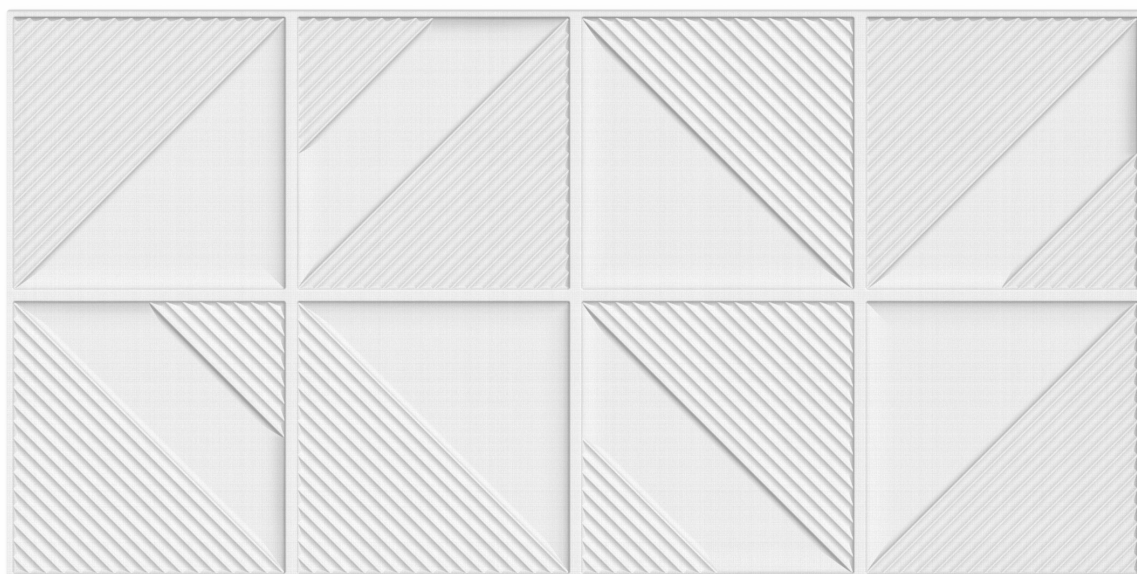

WMAXI (240 x 120 cm)

2. WALL INSTALLATION WITH ISOLSPACE SKIN TAPE AND INCOLLAFACILE ADHESIVE

IsolSPACE Skin Tape and Incollafacile Adhesive ensure a strong, but non-invasive adhesion installation inspired by tile and wall covering installation.

The use of IsolSPACE Skin Tape makes installation procedures easier and faster, remaining, like the Incollafacile Adhesive, completely hidden from view.

Installation of Wall with IsolSPACE Skin Tape and Incollafacile Adhesive requires a few readily available tools.

2.1 INSTALLATION ACCESSORIES AND TOOLS

MATERIAL PROVIDED

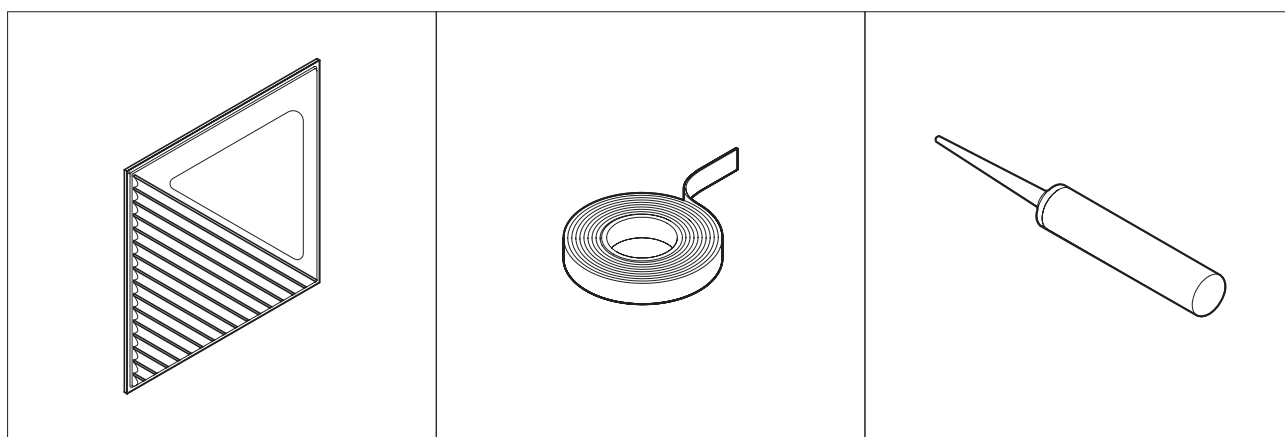

IsolSPACE Skin W1A / W1B / WMAXI

Skin Tape

Incollafacile adhesive

ADDITIONAL TOOLS REQUIRED*

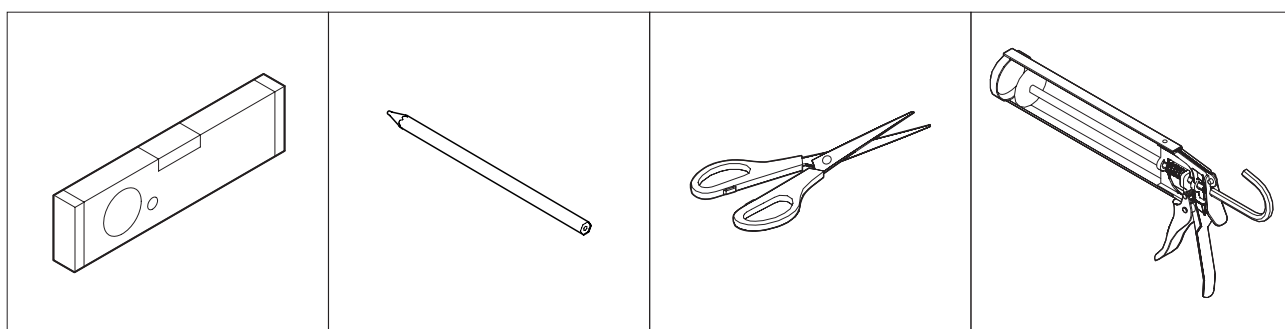

Spirit level

Pencil

Scissors

Silicone gun

*The tools pictured here are not provided, but considered necessary equipment for proper application.



Before mounting, check the condition of the installation surface.

Installation should be done on planar, smooth, compact, non-wet, non-dusty, rigid, non-deformable surfaces.

When working on recently painted surfaces, it is necessary to wait until the paint is completely dry.

The temperature range for proper application of IsolSPACE Skin Tape is -10°C / +60°C

2.2 INSTALLATION INSTRUCTIONS FOR W1A and W1B



Always install the panels starting from the lower left corner of the surface being covered.

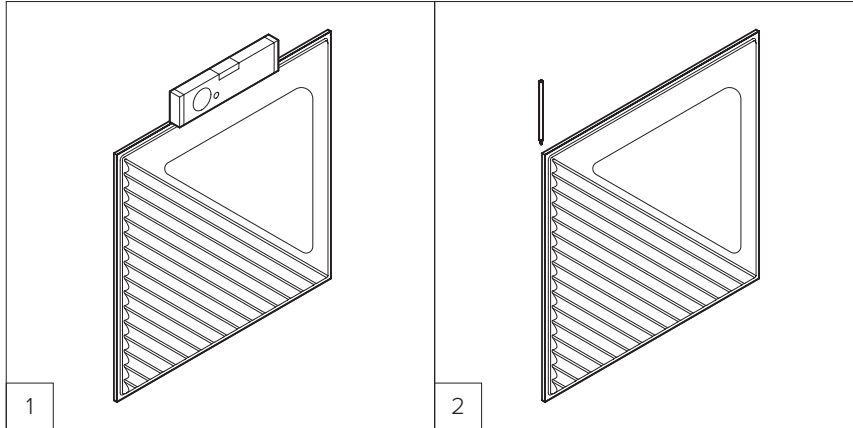

1
Locate the application area, position the product, and check the tilt with the spirit level.

2
Trace the edges with a pencil to define the footprint of the first panel.

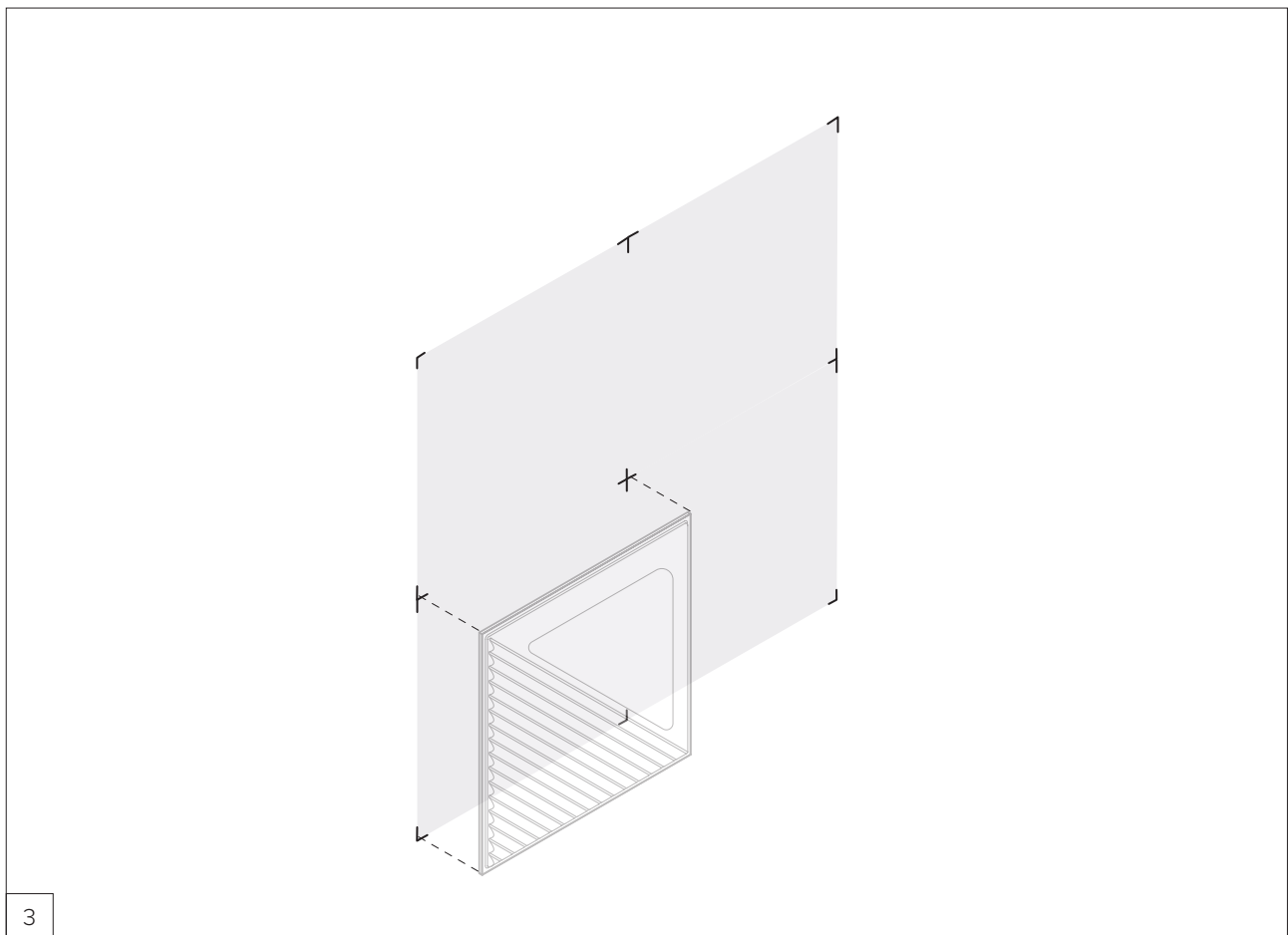

3

Draw the edges of all panels that will be applied to the surface.
The example shows a composition consisting of 4 panels.

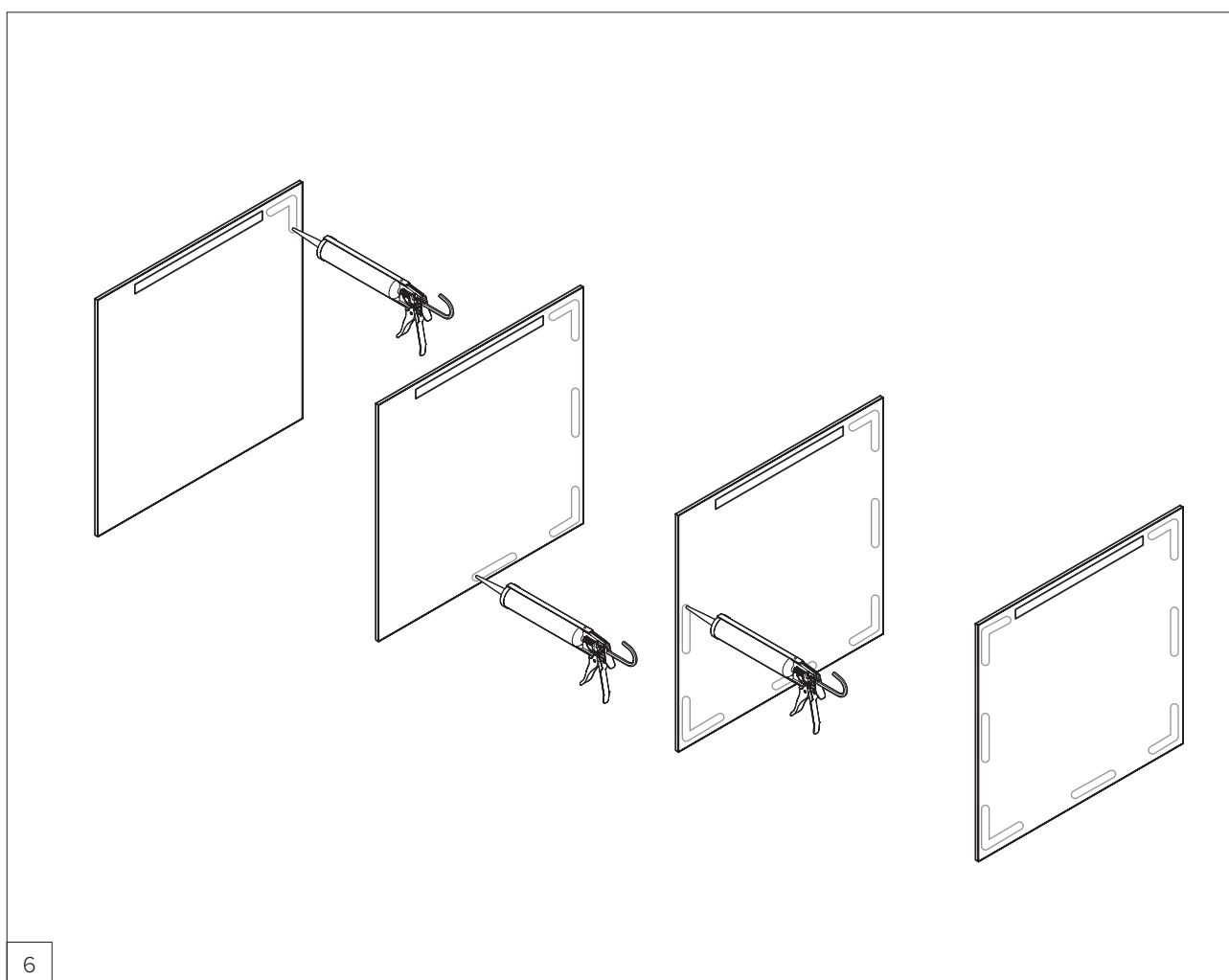
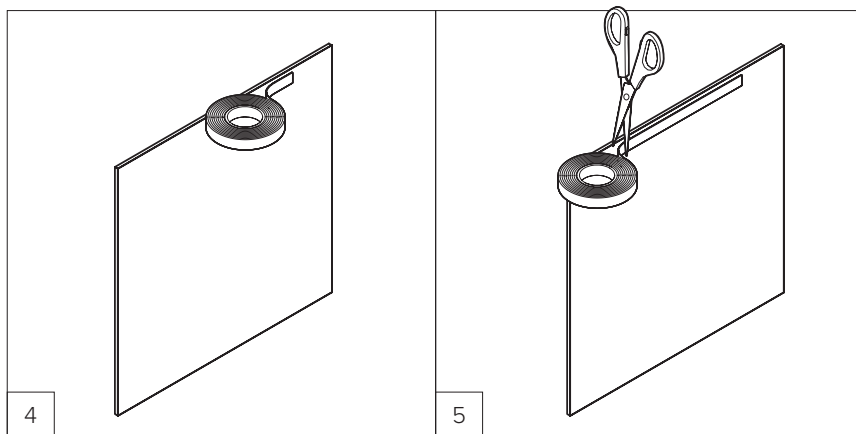

The illustrated application refers to the W1A and W1B products.
To apply the WMAXI product, refer to the instructions on page 8.

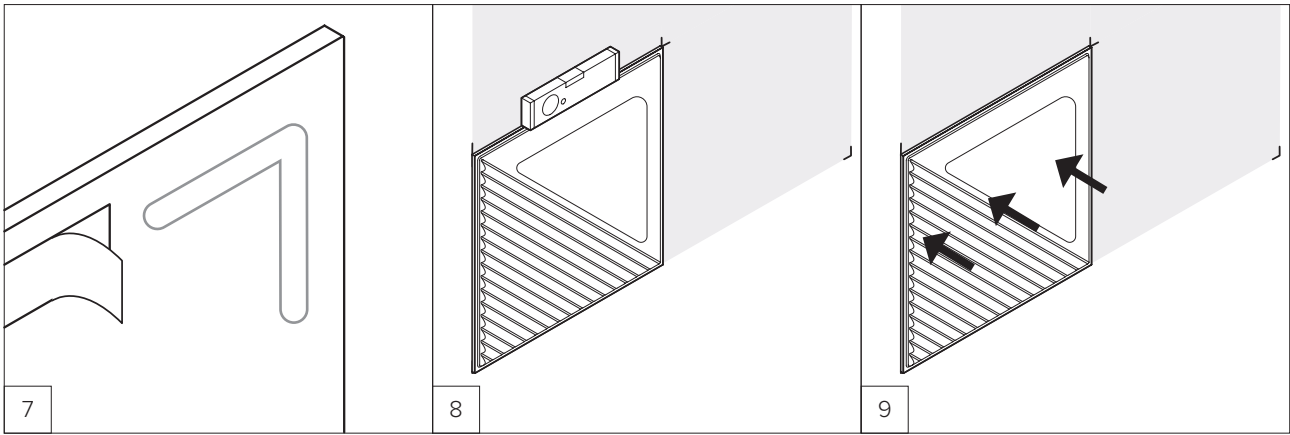

7 Remove the film from the tape.

8 Gently place the panel on the footprint drawn on the wall and check that the tilt is correct with the spirit level.

9 Firmly secure the panel to the wall by applying pressure to it and hold in place for about 30 seconds.

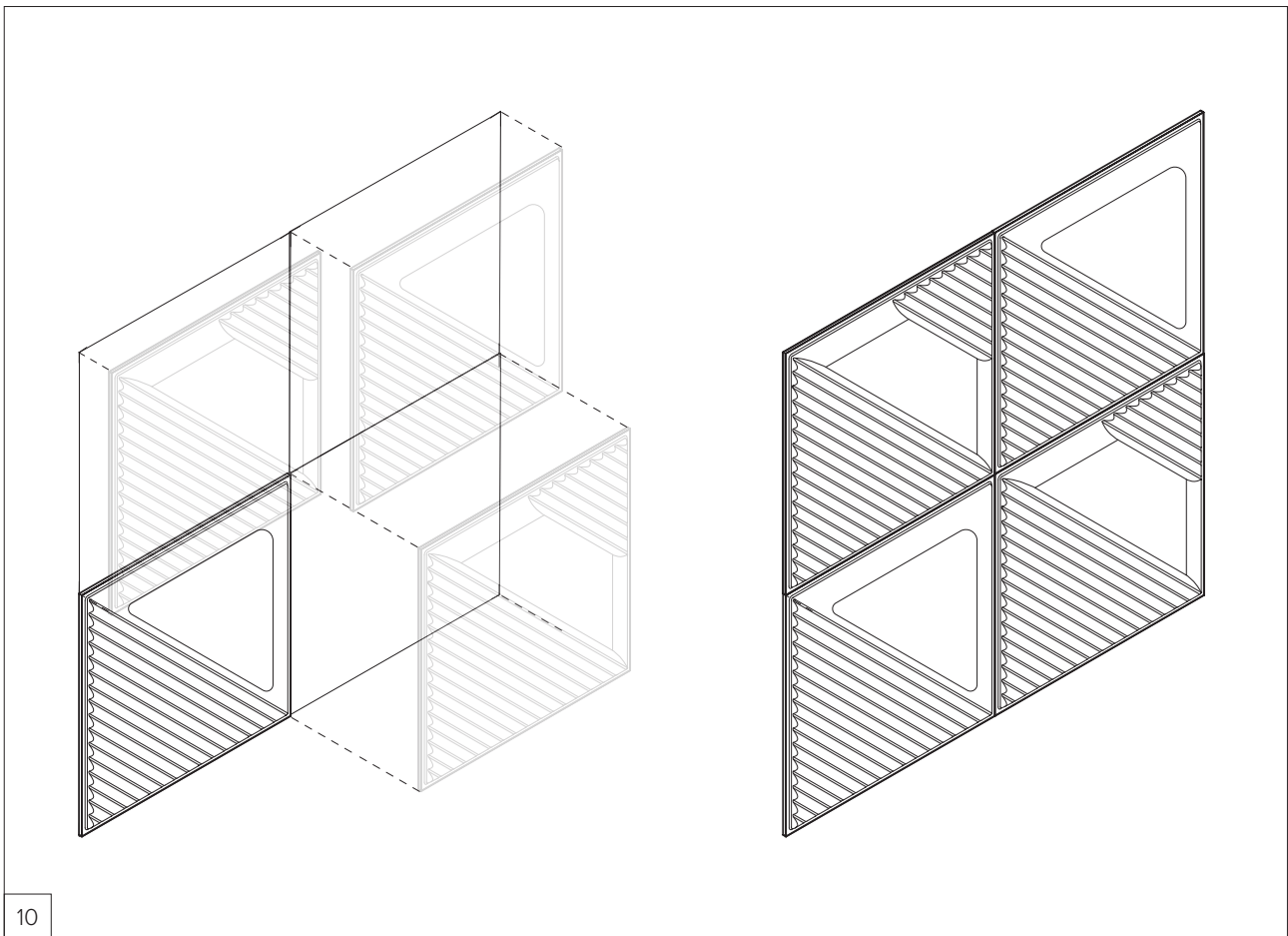

10 Repeat these steps for each panel in the composition, using the already installed panels as a template. The example shows a composition consisting of 4 panels.

2.3 WMAXI INSTALLATION INSTRUCTIONS

The steps for applying the WMAXI product are the same as those shown in section 2.2. Position the Isospace Skin Tape and Incollafacile Adhesive as in the illustration below.

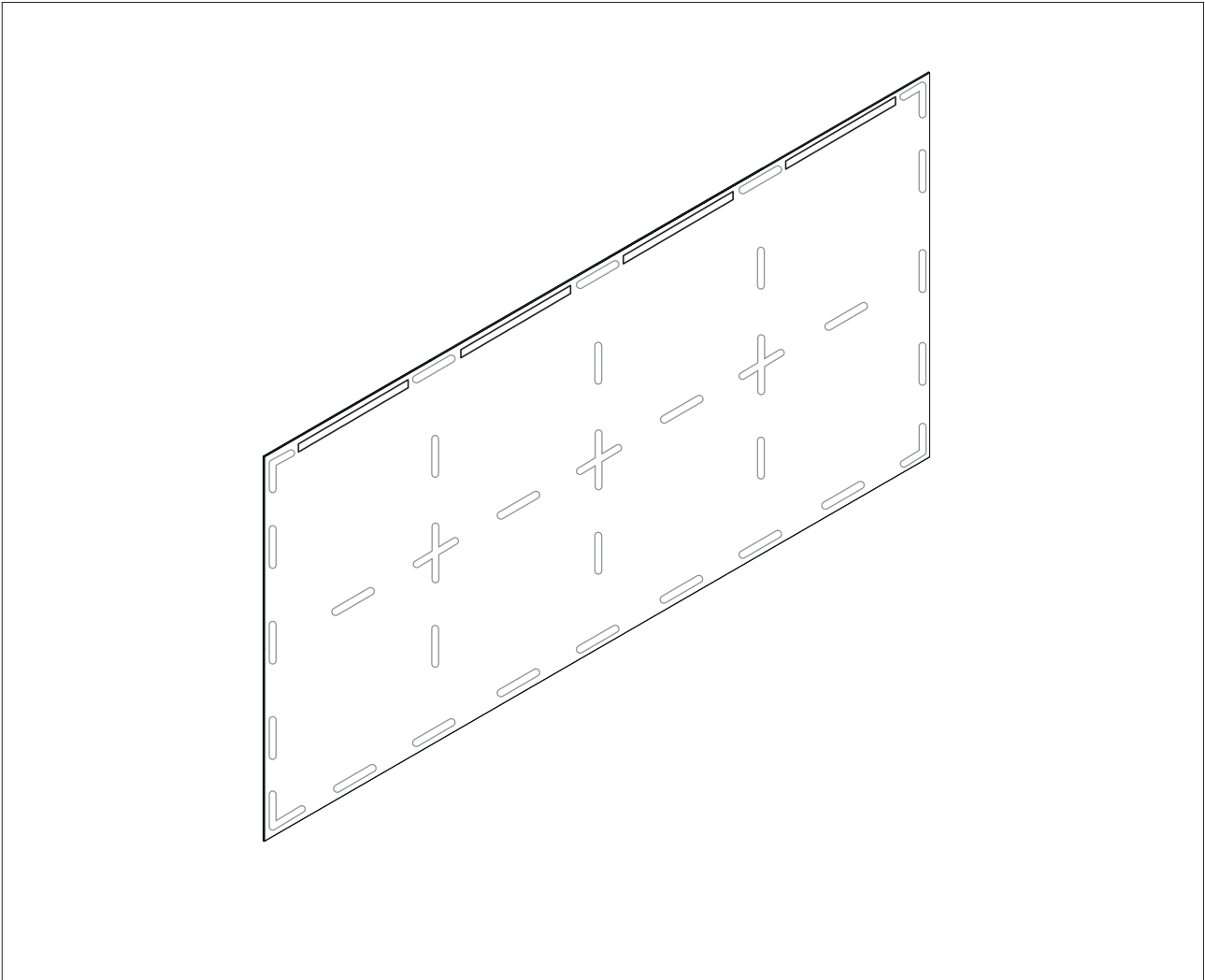

3. WALL INSTALLATION WITH SCREWS

For screwed installation on the wall, the panel is supplied with holes prepared for inserting screws (on request when ordering).

Installation of Isospace Skin Wall with screws and dowels requires the use of readily available tools that are normally used by professional installers.

Any type of screw compatible with the chosen dowel (chosen by the customer based on the installation substrate) can be used.

For a better aesthetic result, screws with flat heads and underheads are recommended. In the case of countersunk underhead screws, an underhead washer for countersunk screws can be inserted between the panel and the screw.

3.1 INSTALLATION ACCESSORIES AND TOOLS

MATERIAL PROVIDED

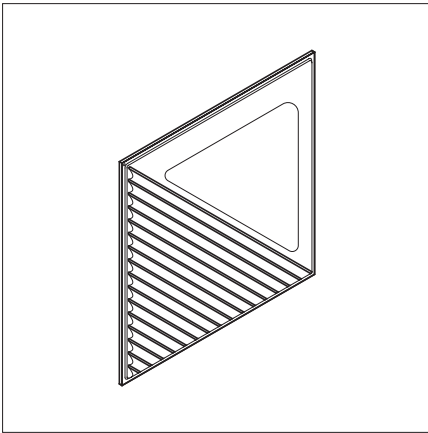

Isospace Skin W1A / W1B / WMAXI

ADDITIONAL TOOLS REQUIRED*

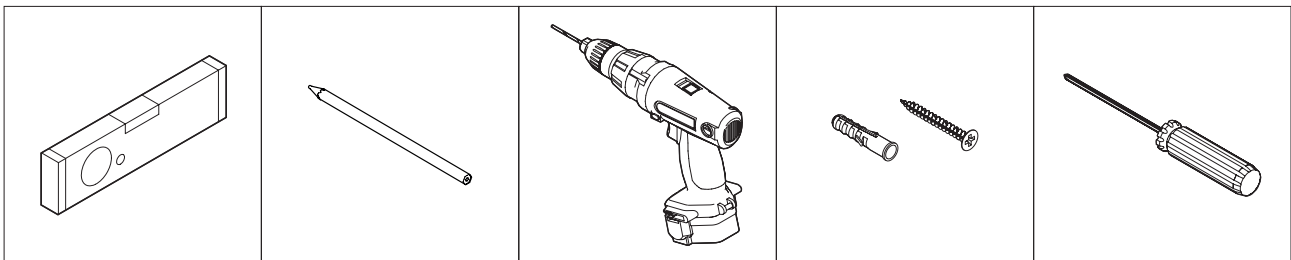

Spirit level

Pencil

Drill

Ø5 mm dowels
and Ø4 mm screws

Screwdriver or
nutrunner

*The tools pictured here are not provided, but considered necessary equipment for proper application.



Before mounting, check the condition of the installation surface.

Installation should be done on planar, smooth, compact, non-wet, non-dusty, rigid, non-deformable surfaces.

When working on recently painted surfaces, it is necessary to wait until the paint is completely dry.

Screws and dowels should be chosen based on the installation substrate.

3.2 INSTALLATION INSTRUCTIONS FOR W1A AND W1B



Always install the panels starting from the lower left corner of the surface being covered

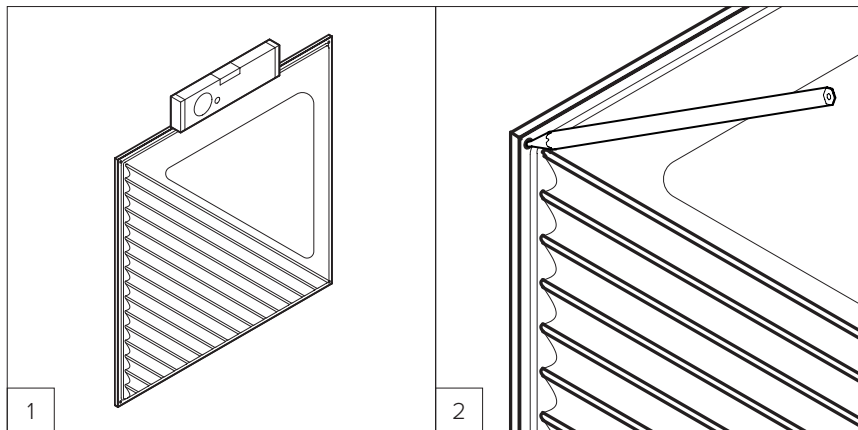

1
Locate the application area, position the product, and check the tilt with the spirit level.

2
Mark the points where the holes will be drilled on the wall, using the panel holes as a template.

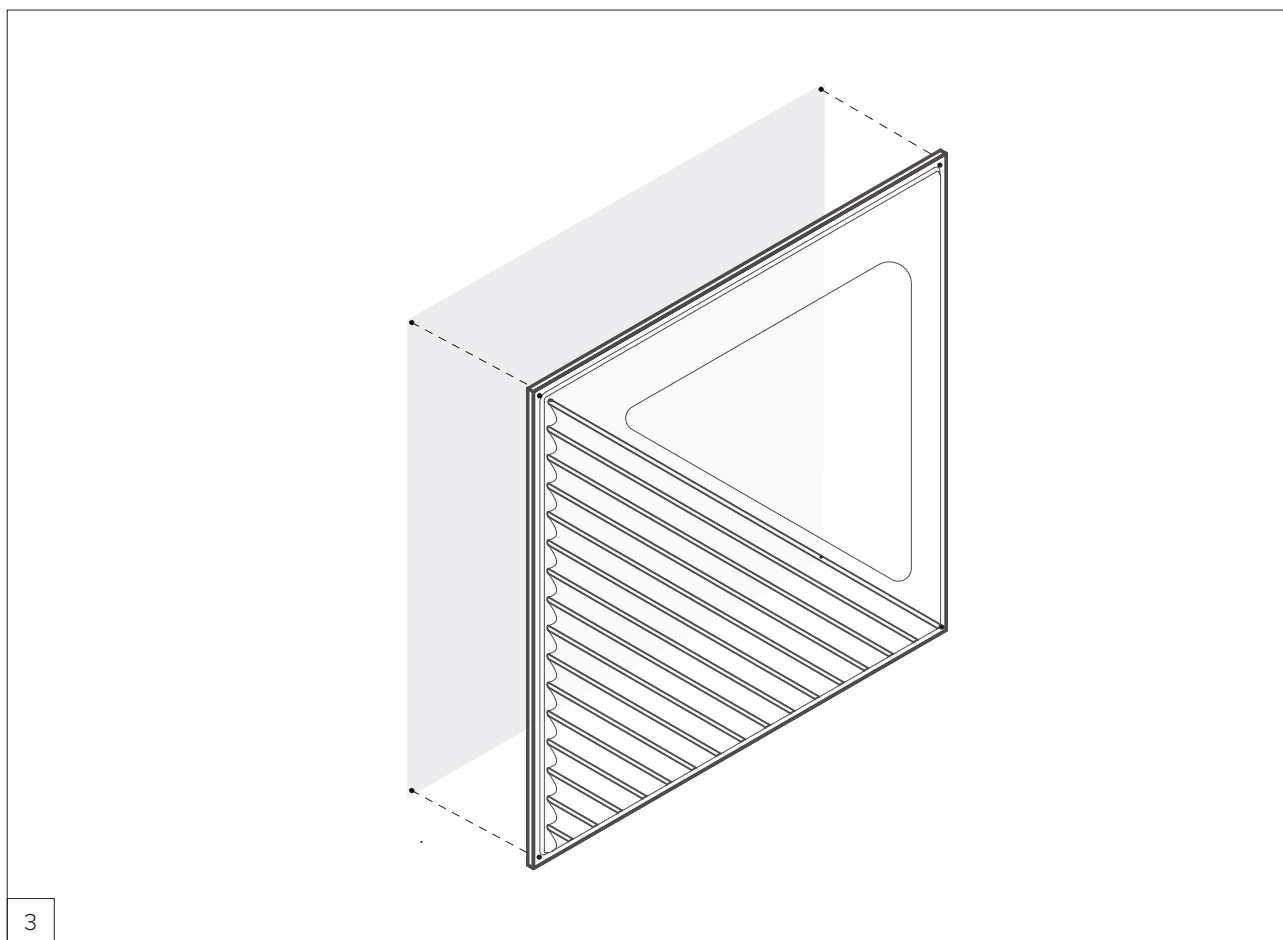

3
Proceed by mounting one panel at a time.

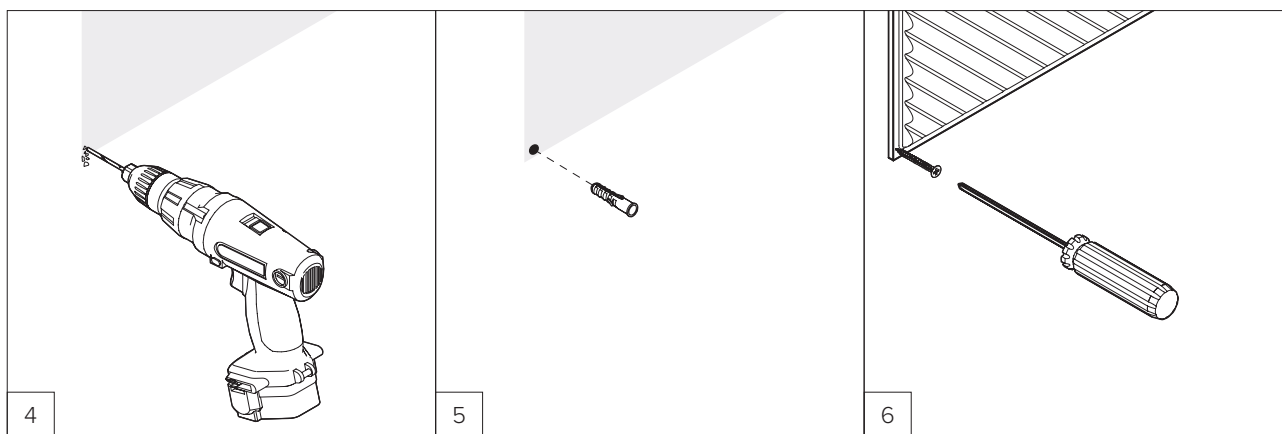

4 Drill the wall by following the previously drawn holes.

5 Insert the dowel into the hole in the wall. Repeat the step for as many holes as required for the individual panel.

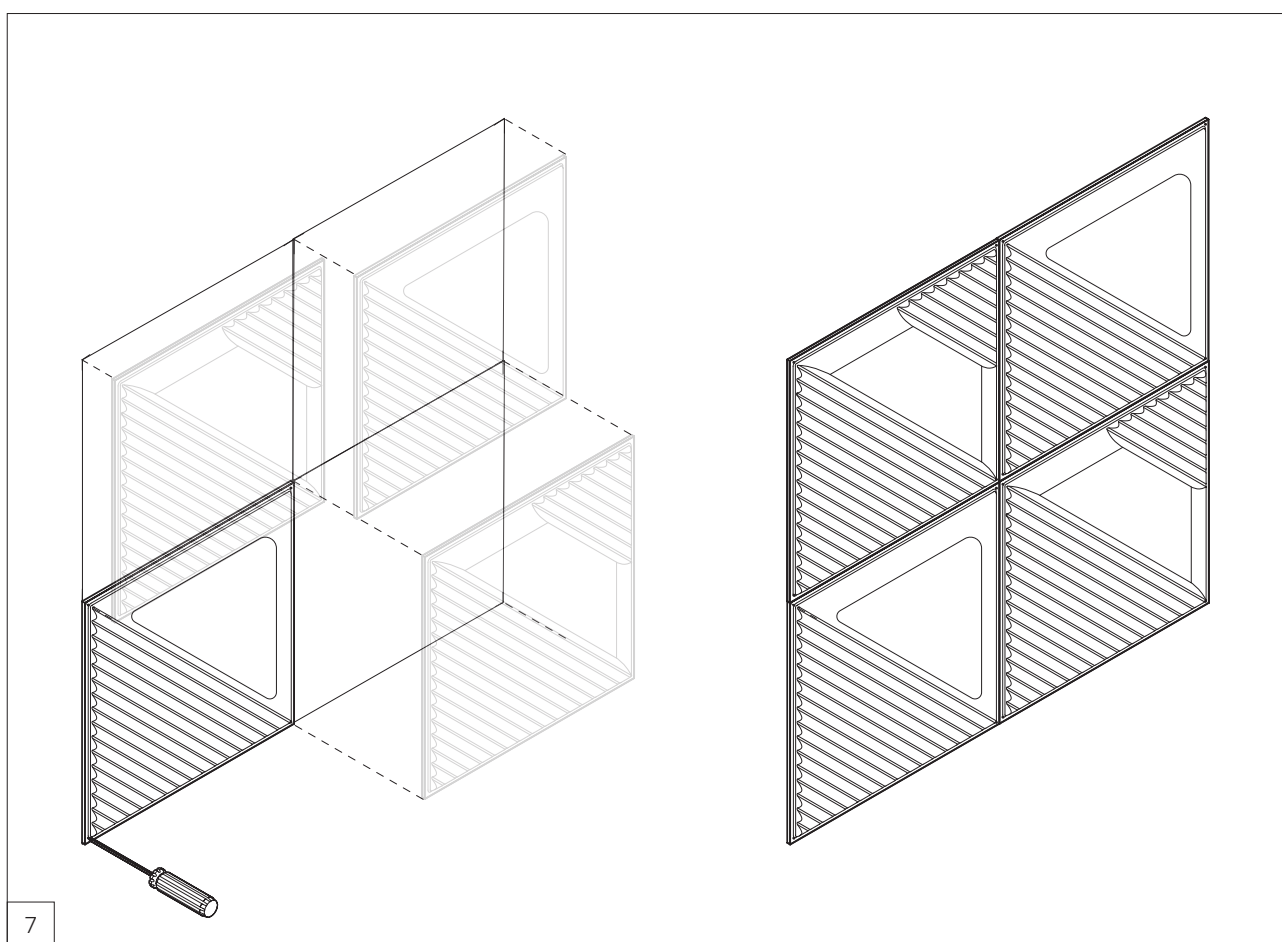

7 Repeat these steps for each panel in the composition, using the already installed panels as a template. The example shows a composition consisting of 4 panels.

3.3 WMAXI INSTALLATION INSTRUCTIONS

The steps for applying the WMAXI product are the same as those shown in section 3.2.
The attachment points are shown in the illustration below.

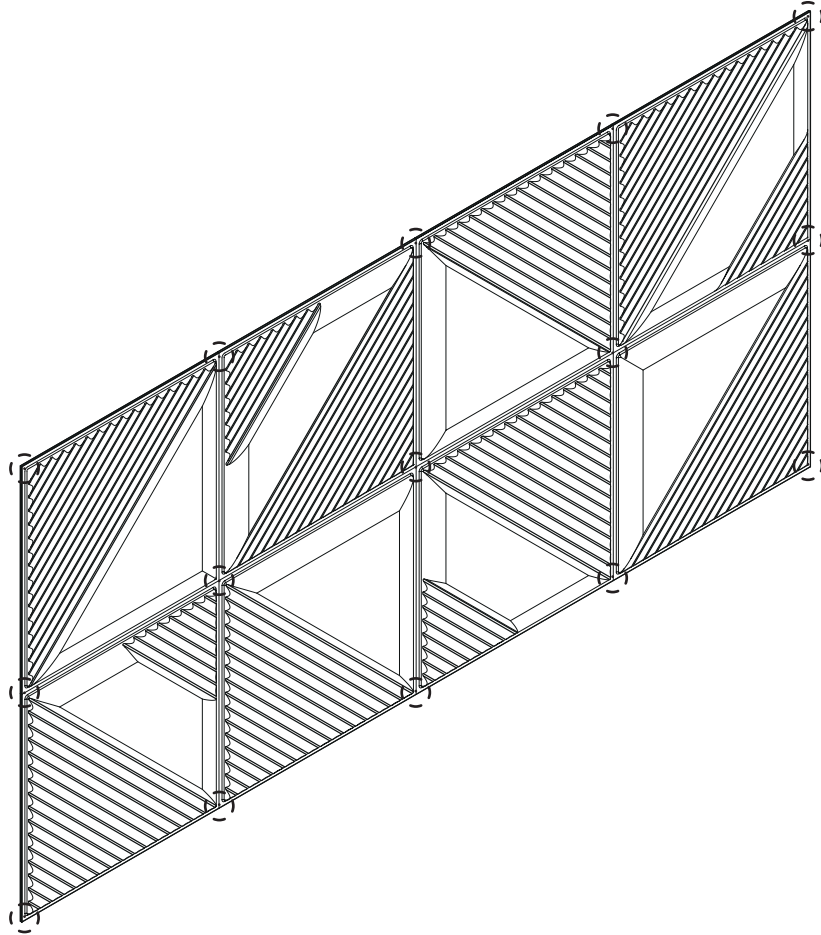

Isospace Skin is a brand of Tecnasfalti
via dell'Industria, 12
Loc. Francolino
20074 Carpiano (MI)

T. +39 02 9885701
E. hello@isolspaceskin.it

isolspaceskin.it

WALL

INSTRUCTIONS FOR WALL INSTALLATION
WITH SCREWS
UNDRILLED PANEL

CONTENTS

1. WALL PRODUCTS	3
2. WALL INSTALLATION WITH SCREWS: UNDRILLED PANEL	4
2.1 Installation accessories and tools	4
2.2 Installation instructions for W1A and W1B	5
2.3 Installation instructions for WMAXI	8

1. WALL PRODUCTS

Wall products are applied in a distinctly simple, fast and clean manner, adhering to walls with concealed or visible accessories.

The single module is available in two versions, W1A and W1B, and allows you to create compositions of various sizes to suit your aesthetic and space requirements. The WMAXI version, which consists of 8 modules, is designed to optimize installation time on particularly large surfaces.

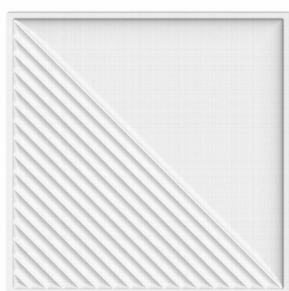

W1A (60 x 60 cm)

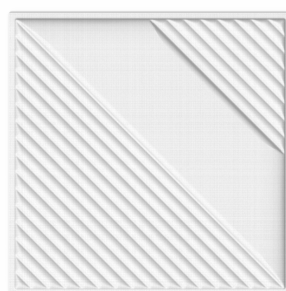

W1B (60 x 60 cm)

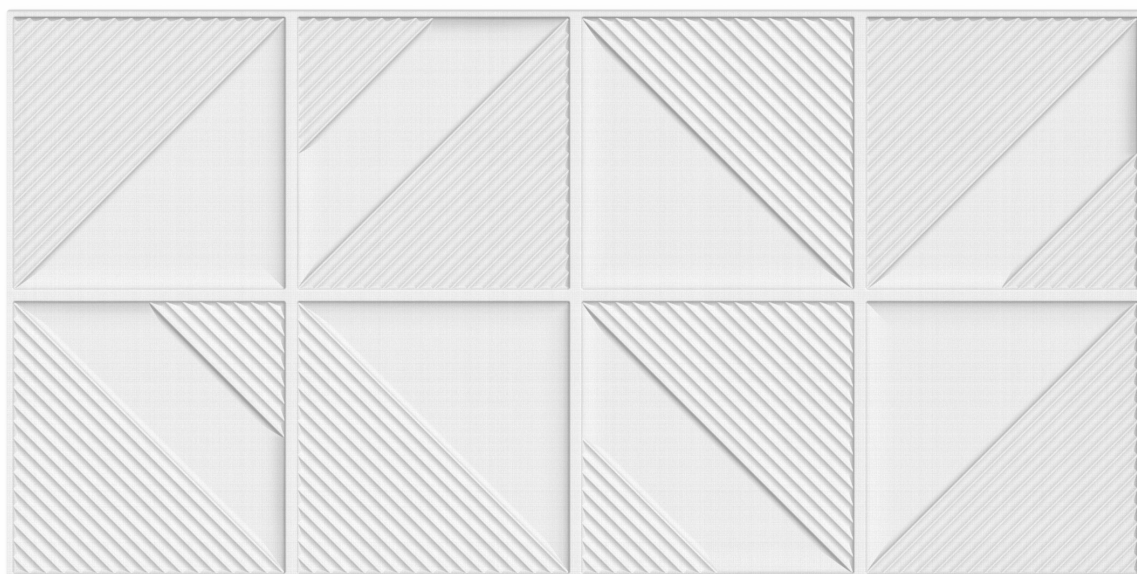

WMAXI (240 x 120 cm)

2. WALL INSTALLATION WITH SCREWS: UNDRILLED PANEL

For screwed installation on the wall, the panel is supplied with holes prepared for inserting screws (on request when ordering). Alternatively, you can create the holes yourself with a drill with a wood drill bit.

Any type of screw compatible with the chosen dowel (chosen by the customer based on the installation substrate) can be used. For a better aesthetic result, screws with flat heads and underheads are recommended. In the case of countersunk underhead screws, an underhead washer for countersunk screws can be inserted between the panel and the screw.

2.1 INSTALLATION ACCESSORIES AND TOOLS

MATERIAL PROVIDED

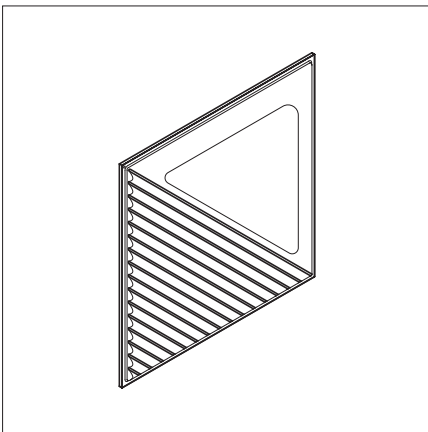

Isospace Skin W1A / W1B / WMAXI

ADDITIONAL TOOLS REQUIRED*

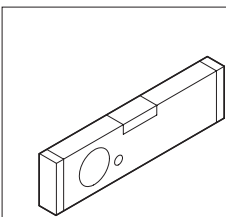

Spirit level

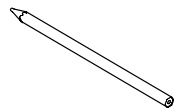

Pencil

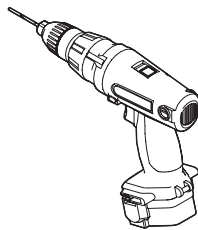

Drill
Wood drill bit



Ø5 mm dowels
and Ø4 mm screws

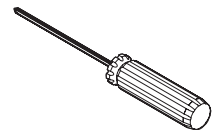

Screwdriver or
nutrunner

*The tools pictured here are not provided, but considered necessary equipment for proper application.



Before mounting, check the condition of the installation surface.

Installation should be done on planar, smooth, compact, non-wet, non-dusty, rigid, non-deformable surfaces.

When working on recently painted surfaces, it is necessary to wait until the paint is completely dry.

Screws and dowels should be chosen based on the installation substrate.

2.2 INSTALLATION INSTRUCTIONS FOR W1A AND W1B



Always install the panels starting from the lower left corner of the surface being covered

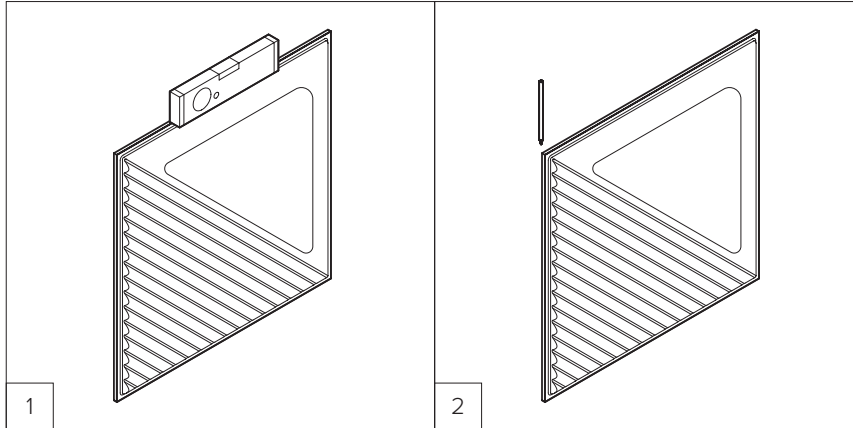

1
Locate the application area, position the product, and check the tilt with the spirit level.

2
Trace the edges with a pencil to define the footprint.

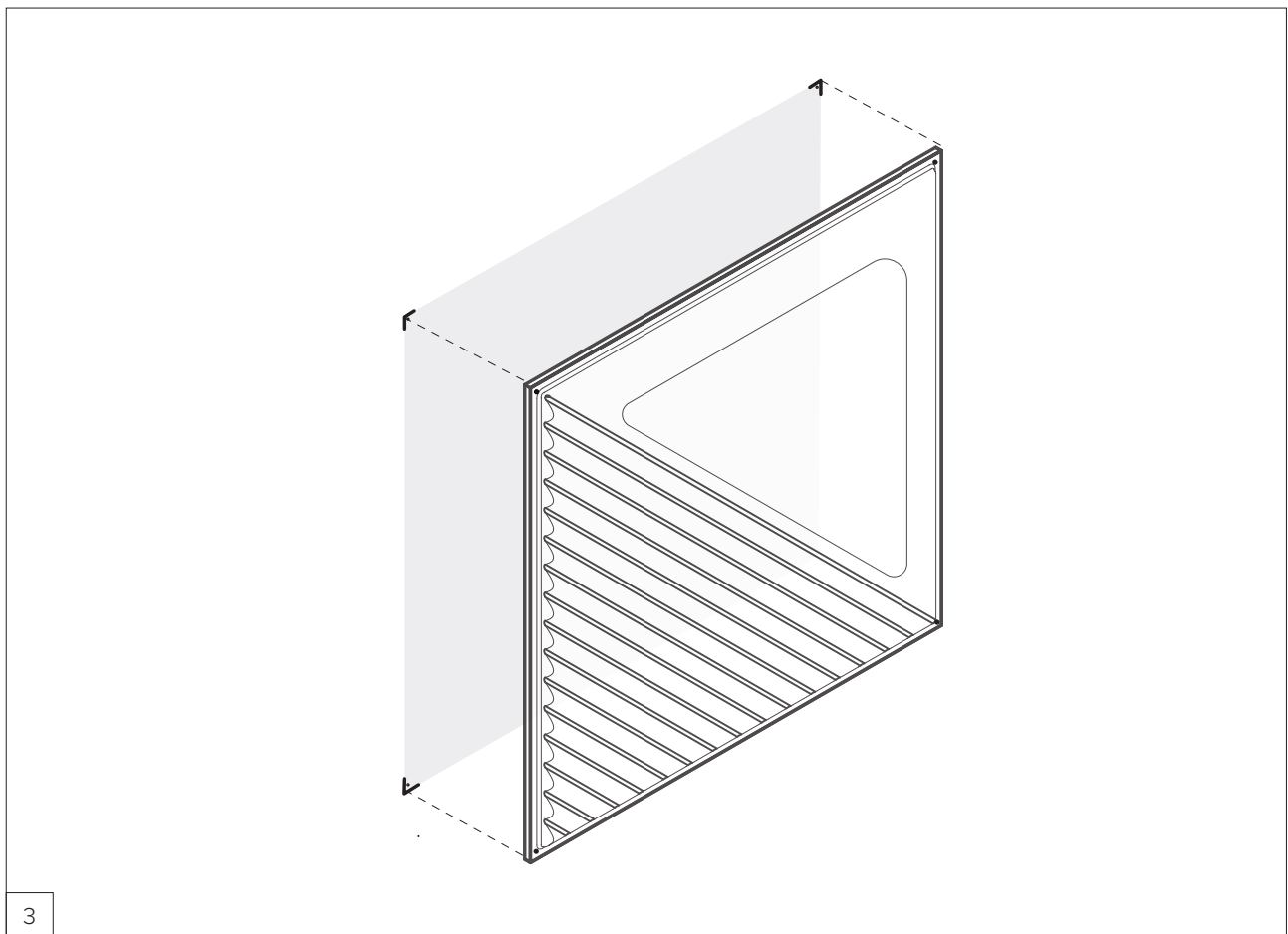

3

Proceed by mounting one panel at a time.

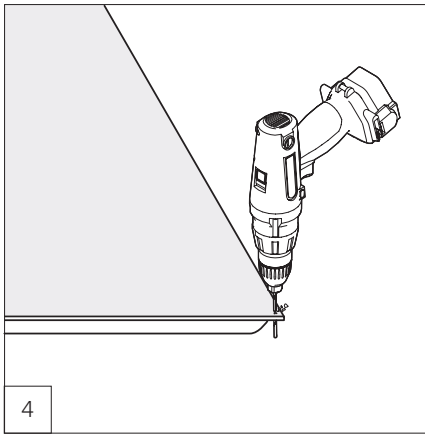

4

Drill the panel on the back, using a wood drill bit, leaving 3 mm on either side of the corner of the panel.

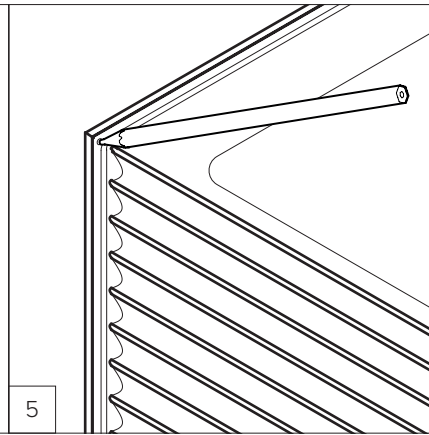

5

Mark the points where the holes will be drilled on the wall, using the newly drilled panel as a template.

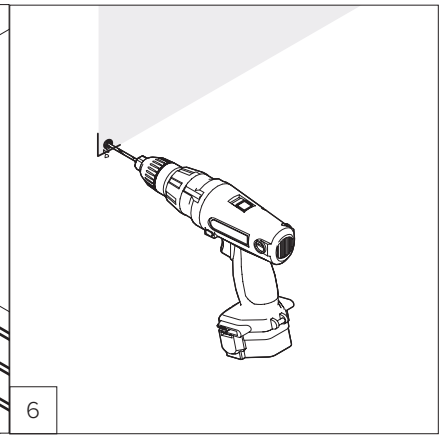

6

Drill the wall by following the previously drawn holes.

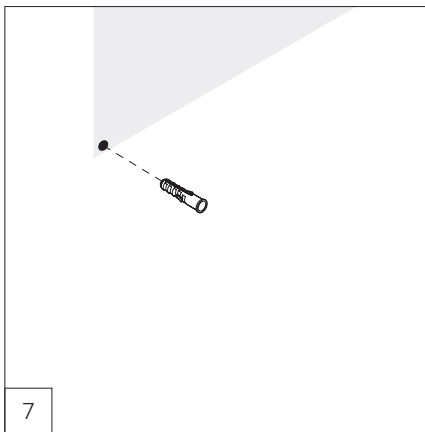

7

Insert the dowel into the hole in the wall.

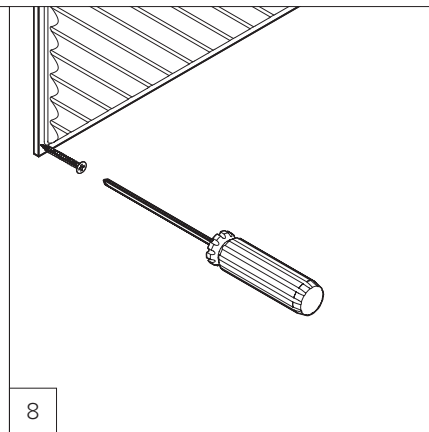

8

Screw the panel to the wall.

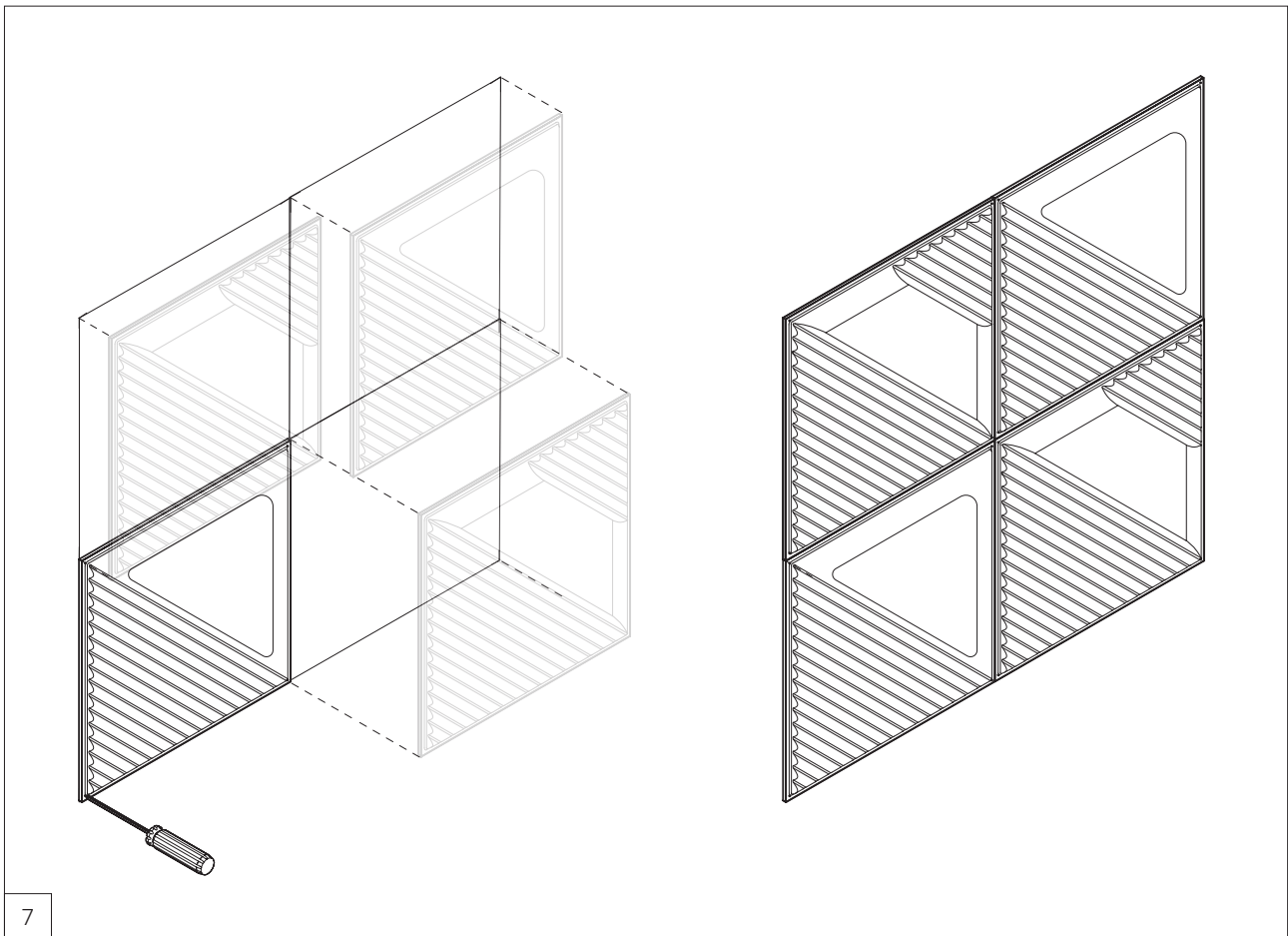

Repeat these steps for each panel in the composition, using the already installed panels as a template. The example shows a composition consisting of 4 panels.

2.3 WMAXI INSTALLATION INSTRUCTIONS

The steps for applying the WMAXI product are the same as those shown in section 2.2.
The attachment points are shown in the illustration below.

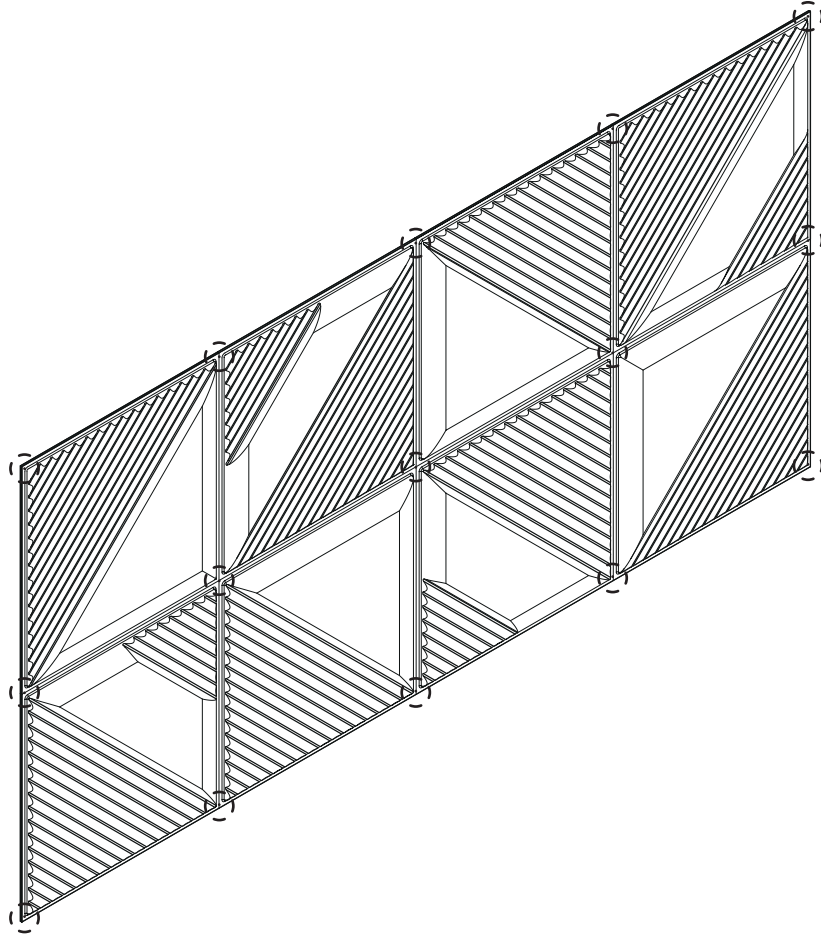

Isospace Skin is a brand of Tecnasfalti
via dell'Industria, 12
Loc. Francolino
20074 Carpiano (MI)

T. +39 02 9885701
E. hello@isolspaceskin.it

isolspaceskin.it

WALL

INSTRUCTIONS FOR WALL INSTALLATION WITH INCOLLAFACILE
ADHESIVE

CONTENTS

1. WALL PRODUCTS	3
2. WALL INSTALLATION WITH INCOLLAFACILE ADHESIVE	4
2.1 Installation accessories and tools	4
2.2 Installation instructions for W1A and W1B	5
2.3 Installation instructions for WMAXI	7

1. WALL PRODUCTS

Wall products are applied in a distinctly simple, fast and clean manner, adhering to walls with concealed or visible accessories.

The single module is available in two versions, W1A and W1B, and allows you to create compositions of various sizes to suit your aesthetic and space requirements. The WMAXI version, which consists of 8 modules, is designed to optimize installation time on particularly large surfaces.

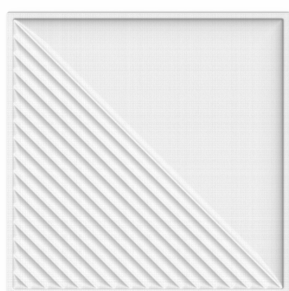

W1A (60 x 60 cm)

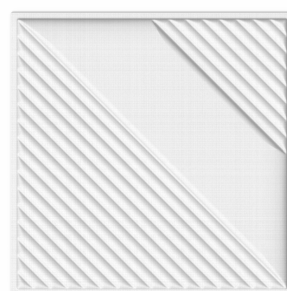

W1B (60 x 60 cm)

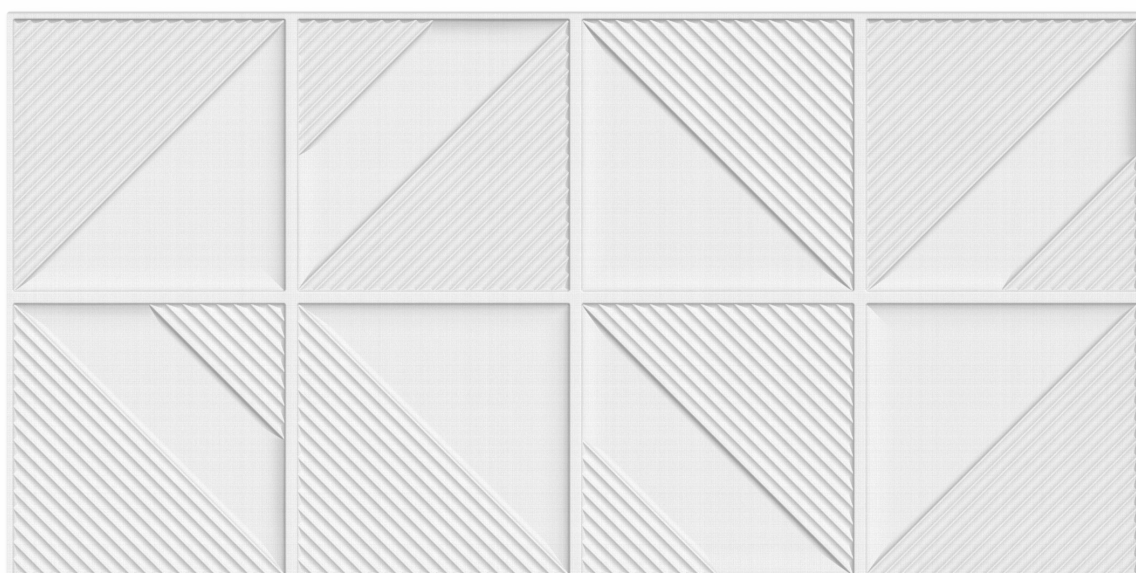

WMAXI (240 x 120 cm)

2. WALL INSTALLATION WITH INCOLLAFACILE ADHESIVE

Isospace Skin panels can be laid using only Incollafacile Adhesive. The installation time depends on the drying time of the adhesive.

2.1 INSTALLATION ACCESSORIES AND TOOLS

MATERIAL PROVIDED

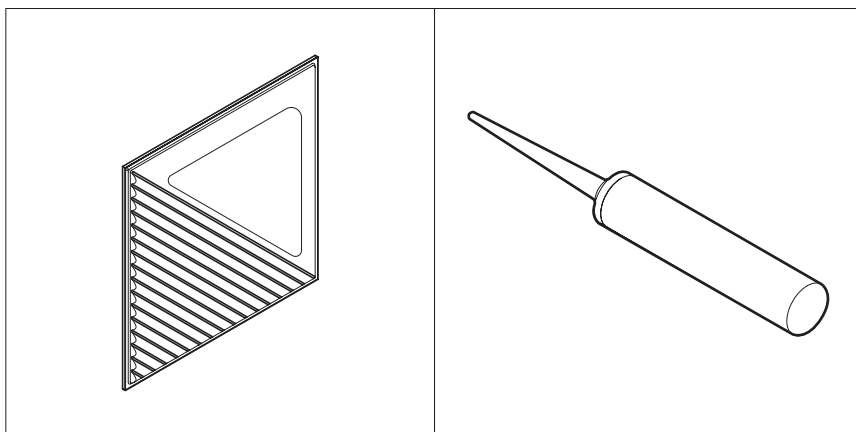

Isospace Skin W1A / W1B / WMAXI Incollafacile adhesive

ADDITIONAL TOOLS REQUIRED*

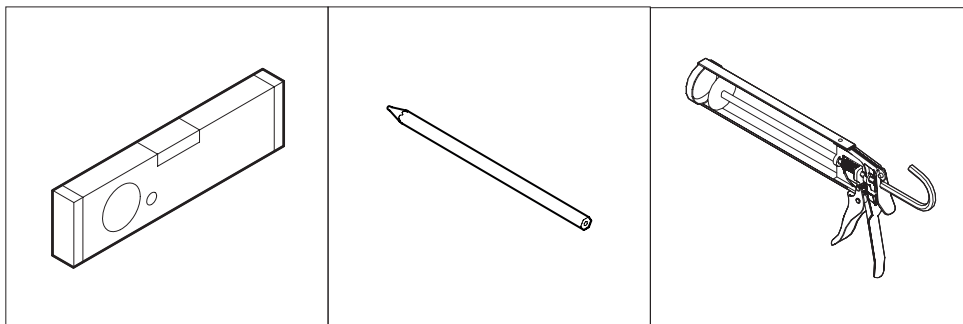

Spirit level

Pencil

Silicone gun

*The tools pictured here are not provided, but considered necessary equipment for proper application.



Before mounting, check the condition of the installation surface.
Installation should be done on planar, smooth, compact, non-wet, non-dusty, rigid, non-deformable surfaces.
When working on recently painted surfaces, it is necessary to wait until the paint is completely dry.

2.2 INSTALLATION INSTRUCTIONS FOR W1A AND W1B



Always install the panels starting from the lower left corner of the surface being covered.

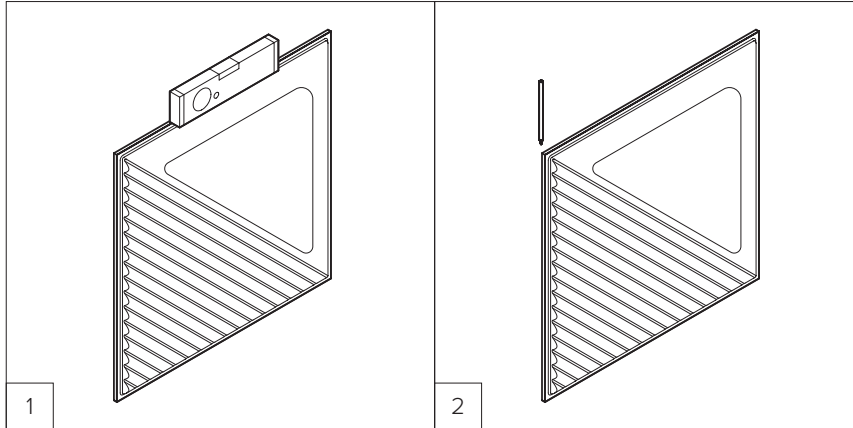

1
Locate the application area, position the product, and check the tilt with the spirit level.

2
Trace the edges with a pencil to define the footprint.

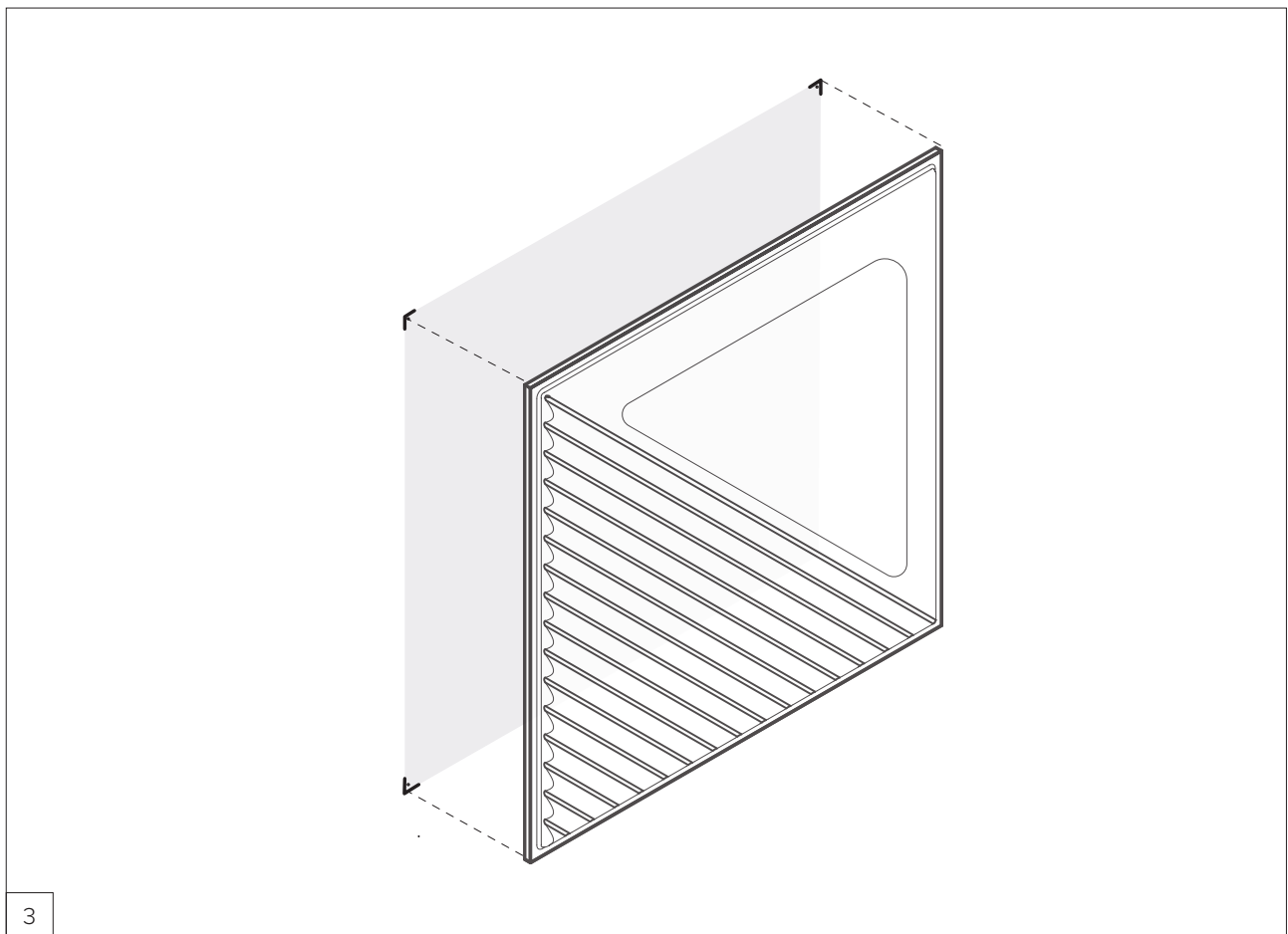

3
Draw the edges of all panels that will be applied to the surface.

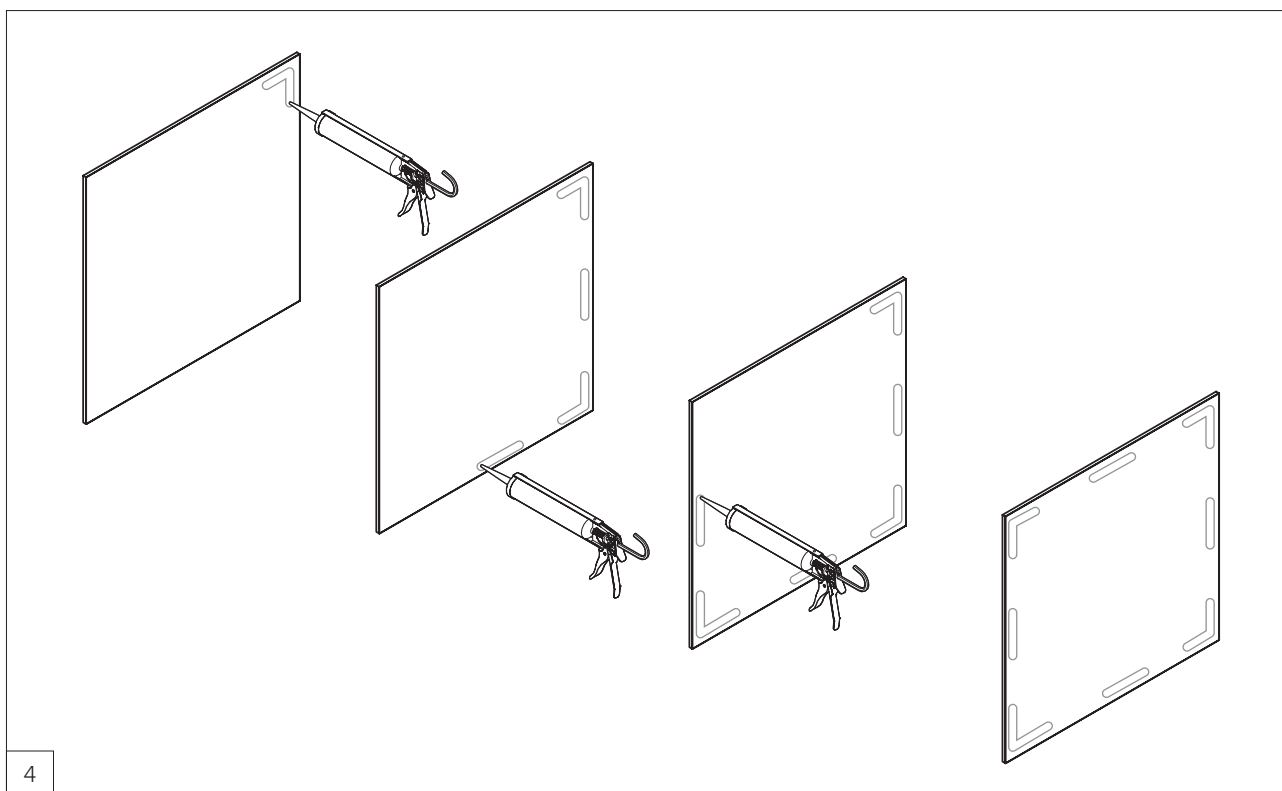

4

Apply Incollafacile adhesive on the panel in the manner shown in the illustration.
Create edging about 8/10 mm thick and 5/6 cm long.

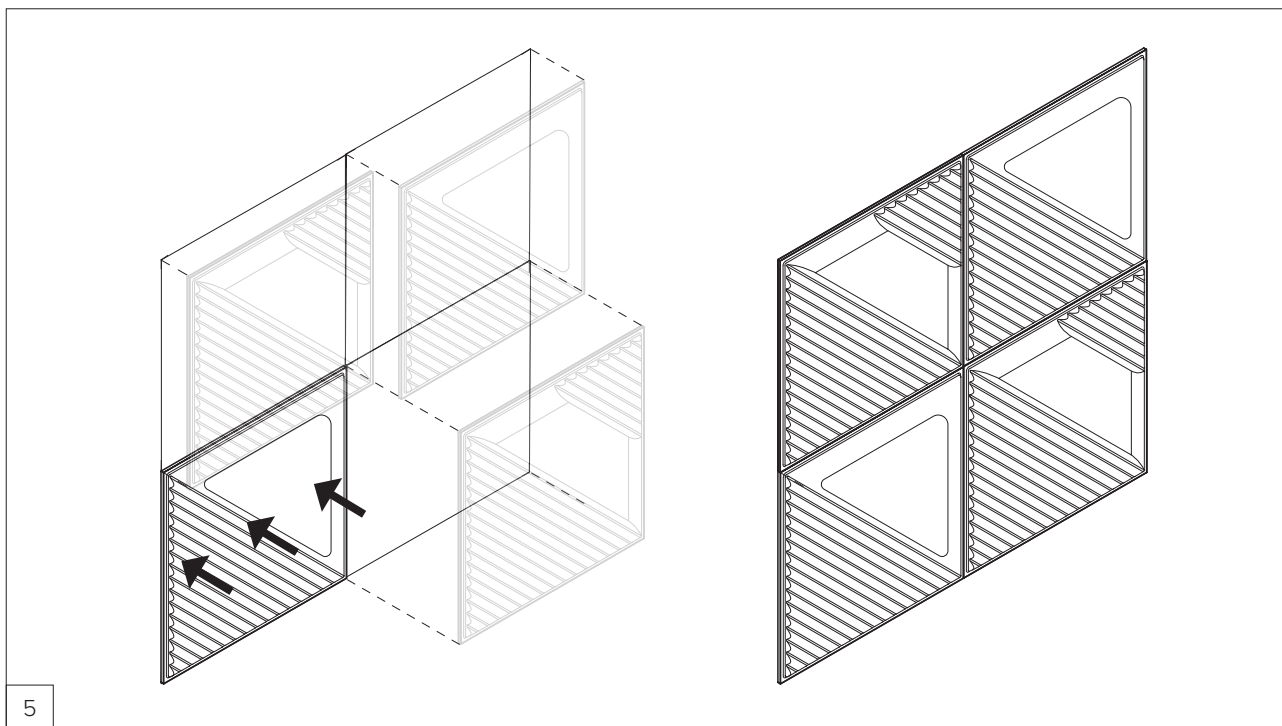

5

Secure the panel to the wall by applying pressure to it and hold in place for about 60 seconds.
The example shows a composition consisting of 4 panels.



The illustrated IsolSPACE Skin Tape application is for the W1A and W1B products.
When applying the tape to the WMAXI product, refer to the instructions on page 7.

2.3 WMAXI INSTALLATION INSTRUCTIONS

Position the Incollafacile adhesive as in the illustration below.

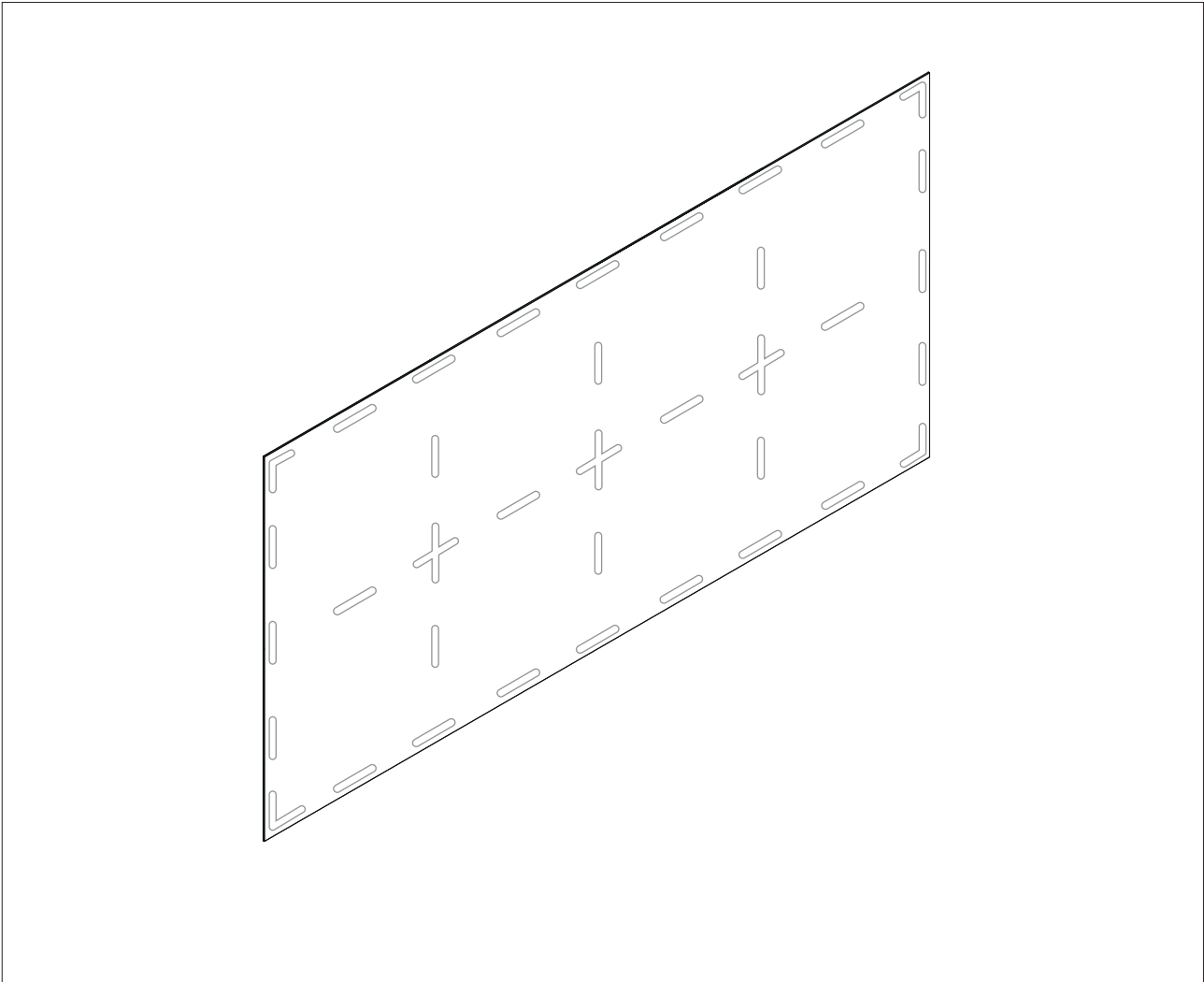

Isospace Skin is a brand of Tecnasfalti
via dell'Industria, 12
Loc. Francolino
20074 Carpiano (MI)

T. +39 02 9885701
E. hello@isolspaceskin.it

isolspaceskin.it

WALL

WALL INSTALLATION WITH ISOLSPACE SKIN TAPE

CONTENTS

1. WALL PRODUCTS	3
2. WALL INSTALLATION WITH ISOLSPACE SKIN	4
2.1 Installation accessories and tools	4
2.2 Installation instructions for W1A and W1B	5
2.3 Installation instructions for WMAXI	8

1. WALL PRODUCTS

Wall products are applied in a distinctly simple, fast and clean manner, adhering to walls with concealed or visible accessories.

The single module is available in two versions, W1A and W1B, and allows you to create compositions of various sizes to suit your aesthetic and space requirements. The WMAXI version, which consists of 8 modules, is designed to optimize installation time on particularly large surfaces.

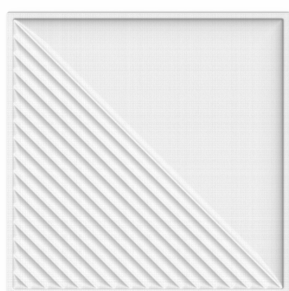

W1A (60 x 60 cm)

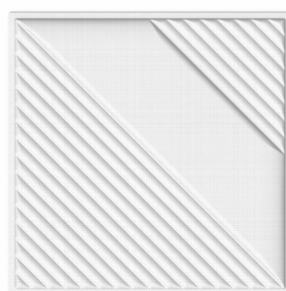

W1B (60 x 60 cm)

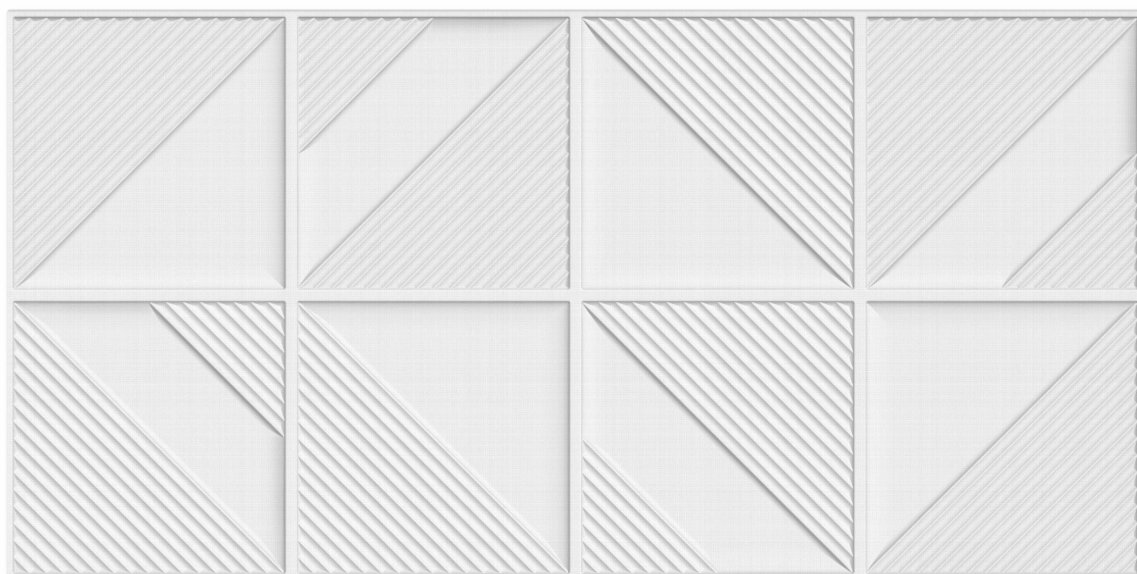

WMAXI (240 x 120 cm)

2. WALL INSTALLATION WITH ISOLSPACE SKIN TAPE

Skin Tape ensures a strong, but non-invasive adhesion installation inspired by tile and wall covering installation. Skin Wall installation requires the use of a few readily available tools.

2.1 INSTALLATION ACCESSORIES AND TOOLS

MATERIAL PROVIDED

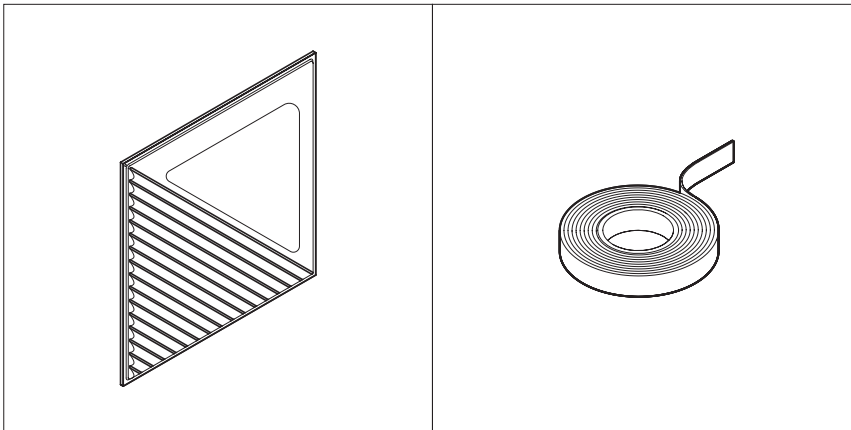

Isospace Skin W1A / W1B / WMAXI Skin Tape

ADDITIONAL TOOLS REQUIRED*

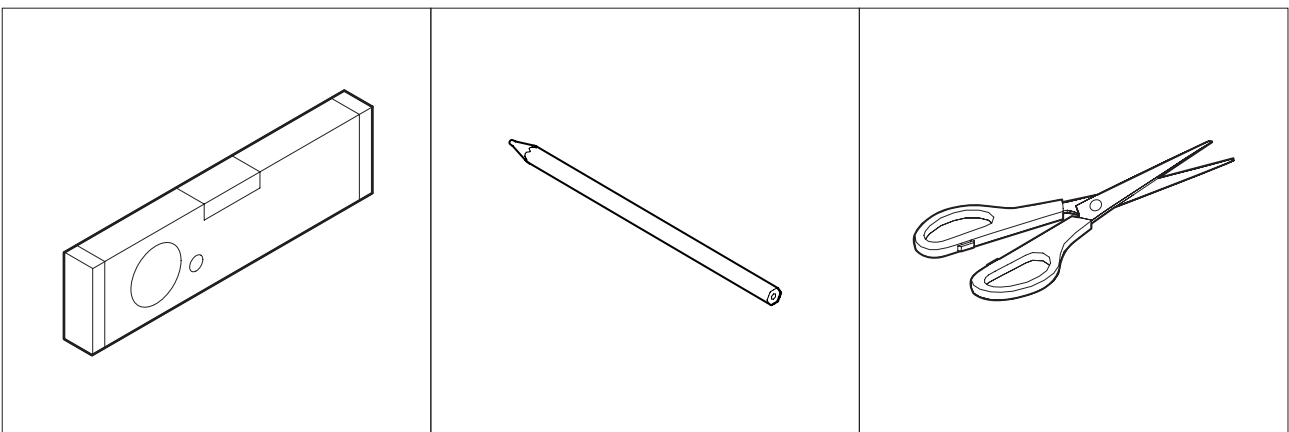

Spirit level

Pencil

Scissors

*The tools pictured here are not provided, but considered necessary equipment for proper application.



Before mounting, check the condition of the installation surface.
Installation should be done on planar, smooth, compact, non-wet, non-dusty, rigid, non-deformable surfaces.
When working on recently painted surfaces, it is necessary to wait until the paint is completely dry.
The temperature range for proper application of Isospace Skin Tape is -10°C / +60°C

2.2 INSTALLATION INSTRUCTIONS FOR W1A and W1B



Always install the panels starting from the lower left corner of the surface being covered.

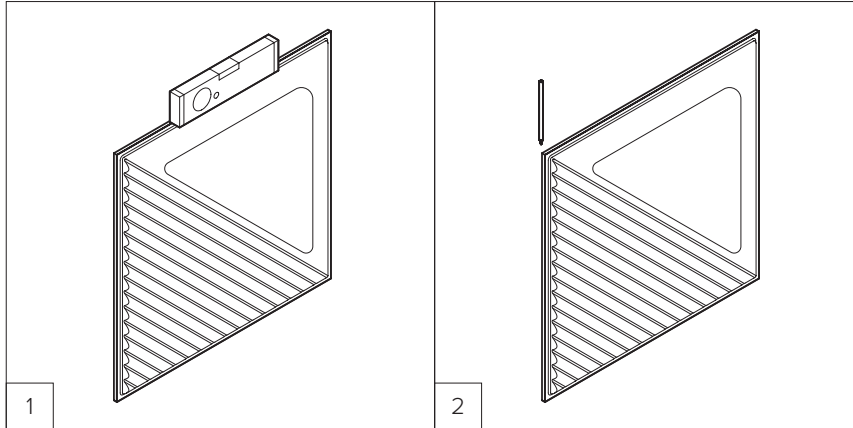

1
Locate the application area, position the product, and check the tilt with the spirit level.

2
Trace the edges with a pencil to define the footprint of the first panel.

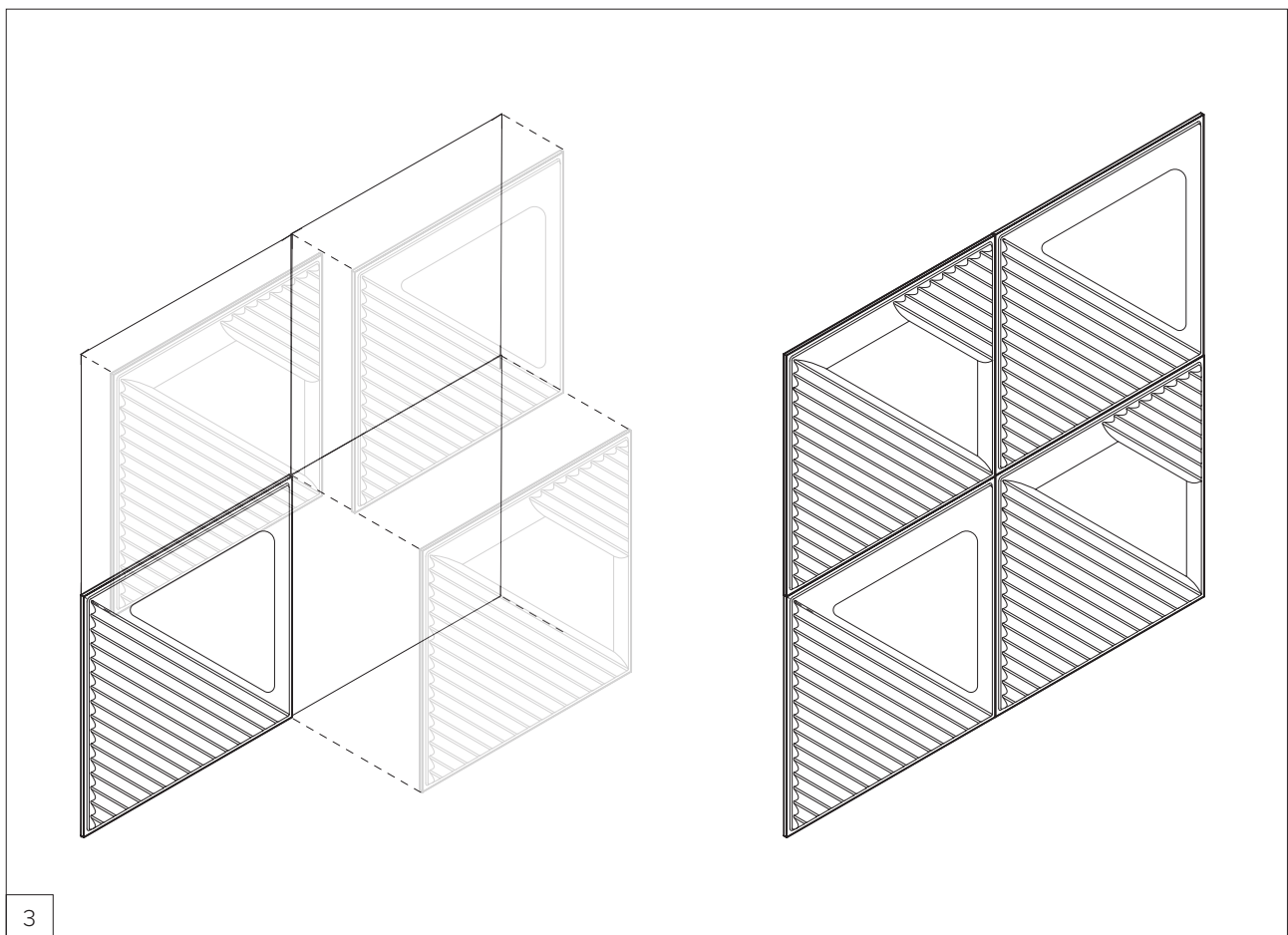

3
Repeat these steps for each panel in the composition, using the already installed panels as a template. The example shows a composition consisting of 4 panels.

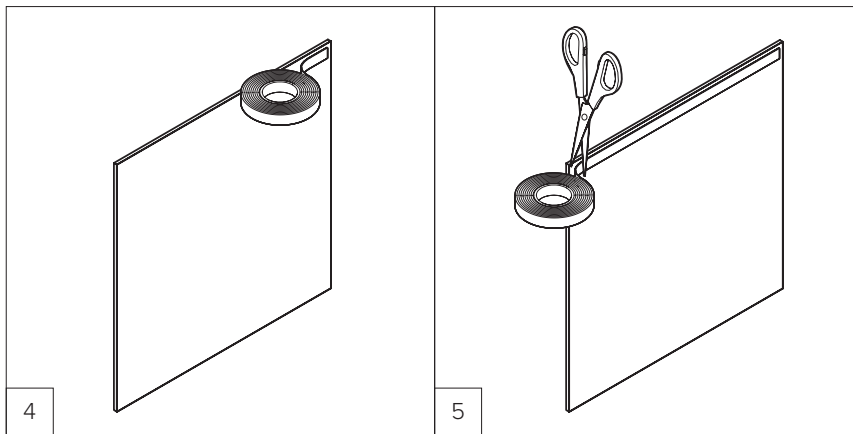

4
Unroll and stick the adhesive part of the tape to the back of the panel, about 5 mm from the edge.

5
Cut the tape at the end of the panel (length about 59 cm) and press it against the panel to ensure firm adhesion.

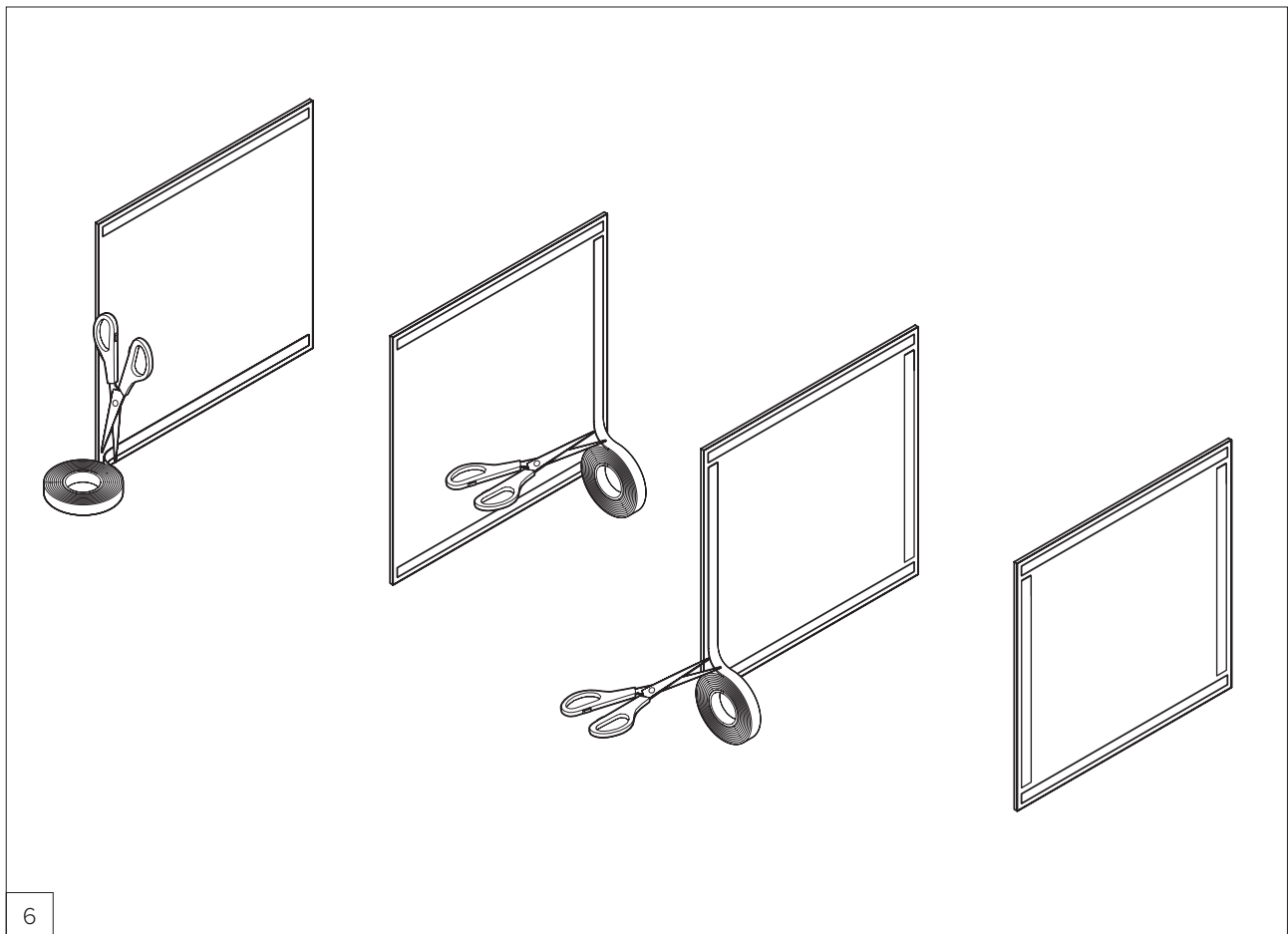

6
Repeat this step on each side of the panel.



The illustrated Isolspace Skin Tape application is for the W1A and W1B products. When applying the tape to the WMAXI product, refer to the instructions on page 8.

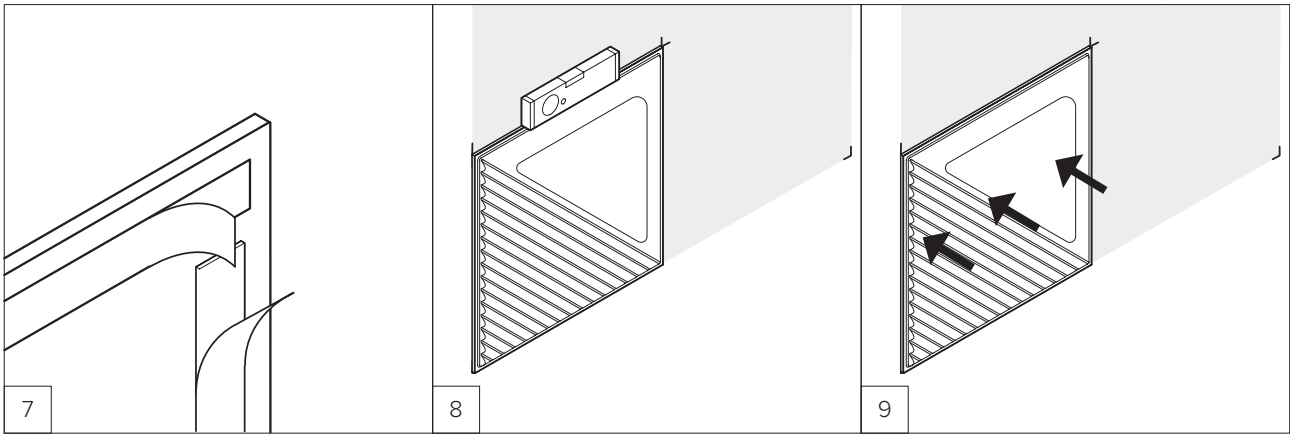

Remove the film from the tape.

Gently place the panel on the footprint drawn on the wall and check that the tilt is correct with the spirit level.

Firmly secure the panel to the wall by applying pressure to it.

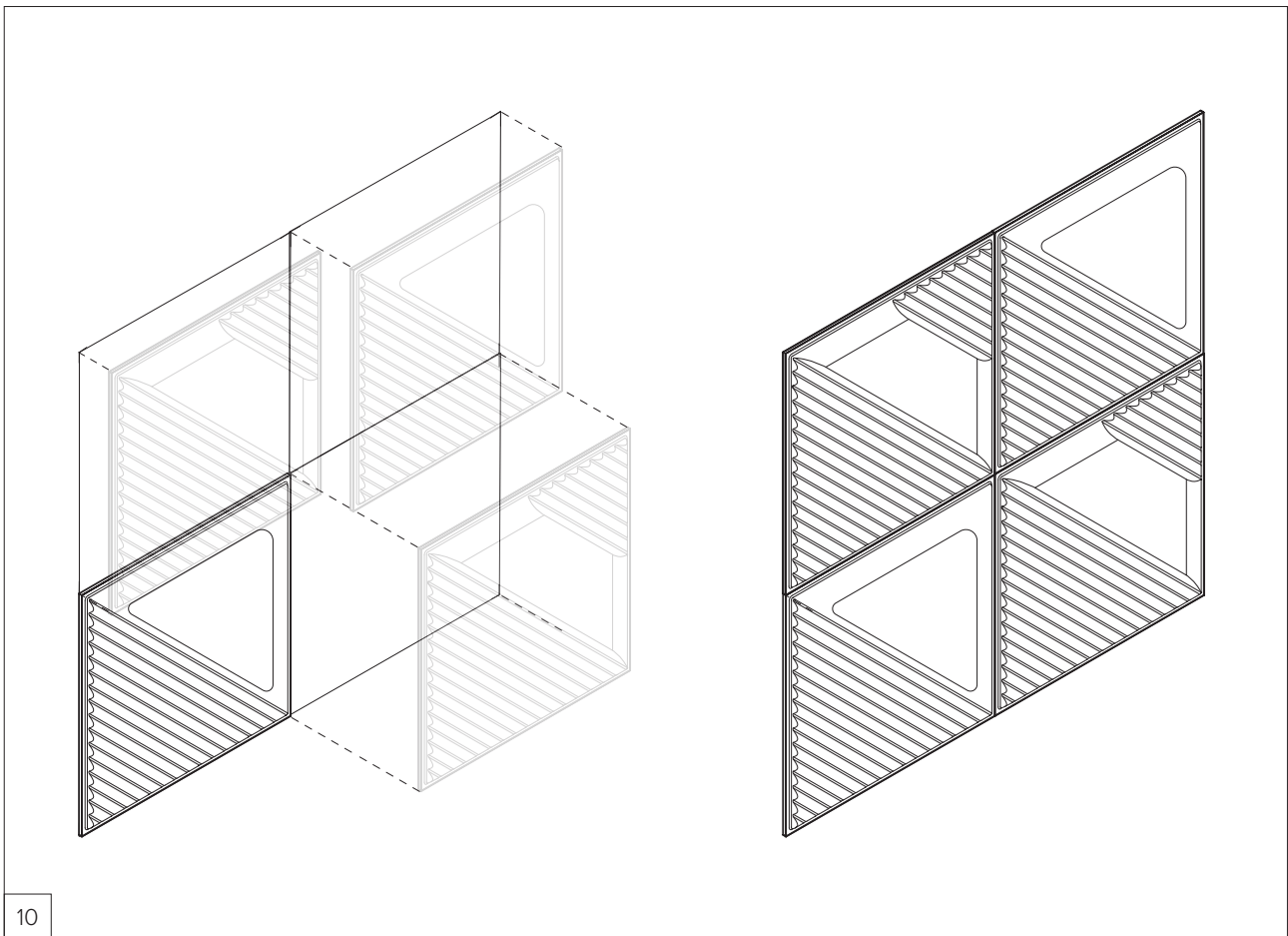

Repeat these steps for each panel in the composition, using the already installed panels as a template. The example shows a composition consisting of 4 panels.

2.3 WMAXI INSTALLATION INSTRUCTIONS

Position the IsolSpace Skin Tape as in the illustration below.

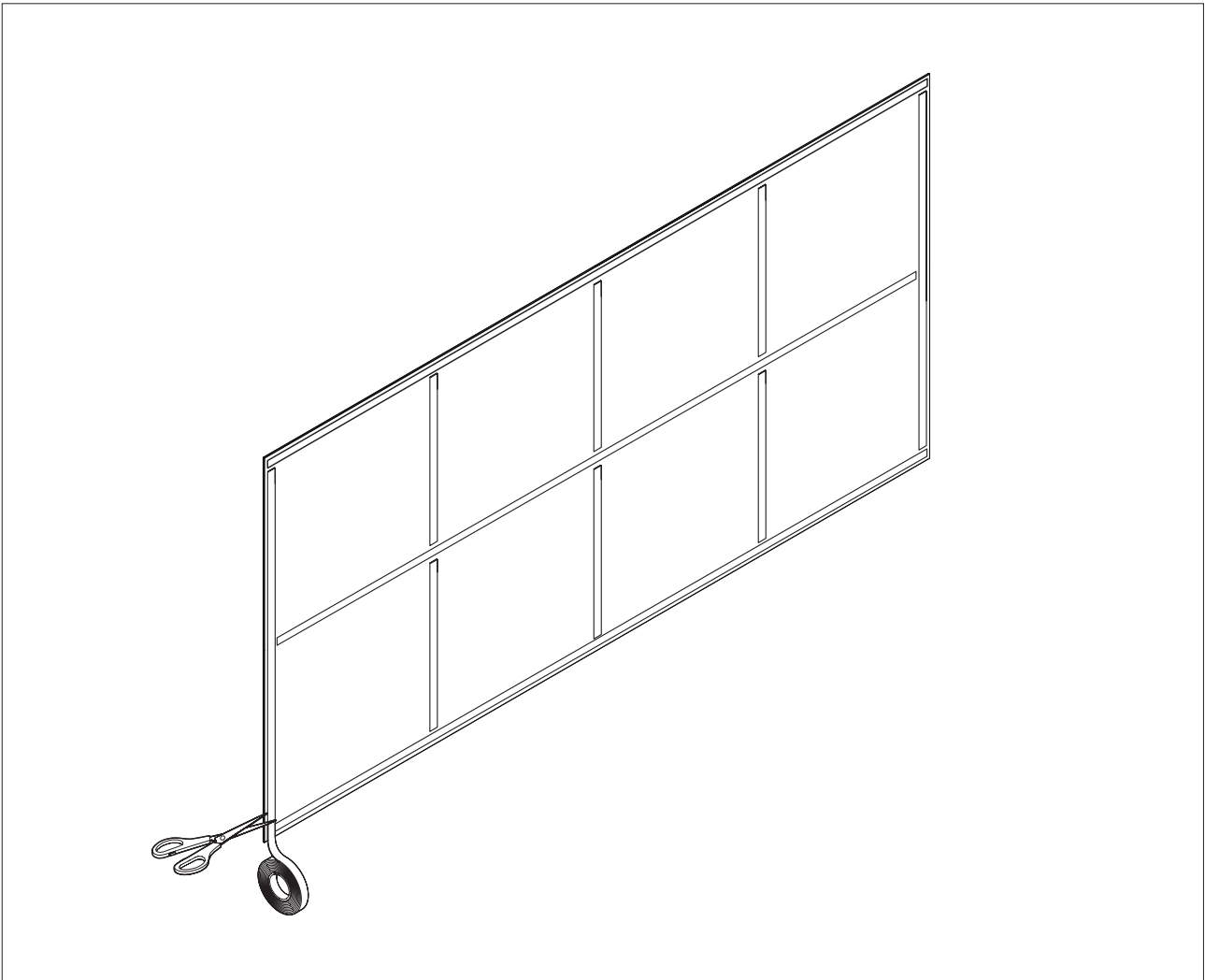

Isospace Skin is a brand of Tecnasfalti
via dell'Industria, 12
Loc. Francolino
20074 Carpiano (MI)

T. +39 02 9885701
E. hello@isolspaceskin.it

isolspaceskin.it